



Churchill Gardens

London, SW1V

£495,000

Two bedroom apartment set within a well maintained ex-local authority building on the popular Churchill Gardens development in SW1V. Accessed from the first floor and arranged over 701 sq ft, the accommodation comprises of an entrance hallway, living room with door opening on to balcony, two double bedrooms, kitchen, bathroom and separate WC. The property has just been extensively refurbished which includes a newly refitted kitchen, redecoration and newly laid flooring. Building with lift(s). No onward chain.

Local Authority: Westminster

Council Tax: Band C

Tenure: Leasehold

Lease: 83 years remaining (estimate approx. £6k-£9k plus legal costs to add a further 90 years on top of the 83 existing)

Service charge: £2930.00 per annum which includes hot water and heating

Ground Rent: £10 per annum fixed for term

Disclaimer: The furnished photos used have been digitally staged for illustrative purposes. The property is currently unfurnished. Please check out the virtual tour showing the full specification and the property as currently laid out.

- Two Bedroom Apartment
- Second Floor (building with lifts)
- Recently Rennovated
- Lots of Natural Light
- Close to Amenities
- No Chain

Viewing

Please contact our Intra Capital Estates Office on 0207 183 6676 if you wish to arrange a viewing appointment for this property or require further information.

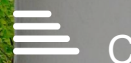

Floor Plan

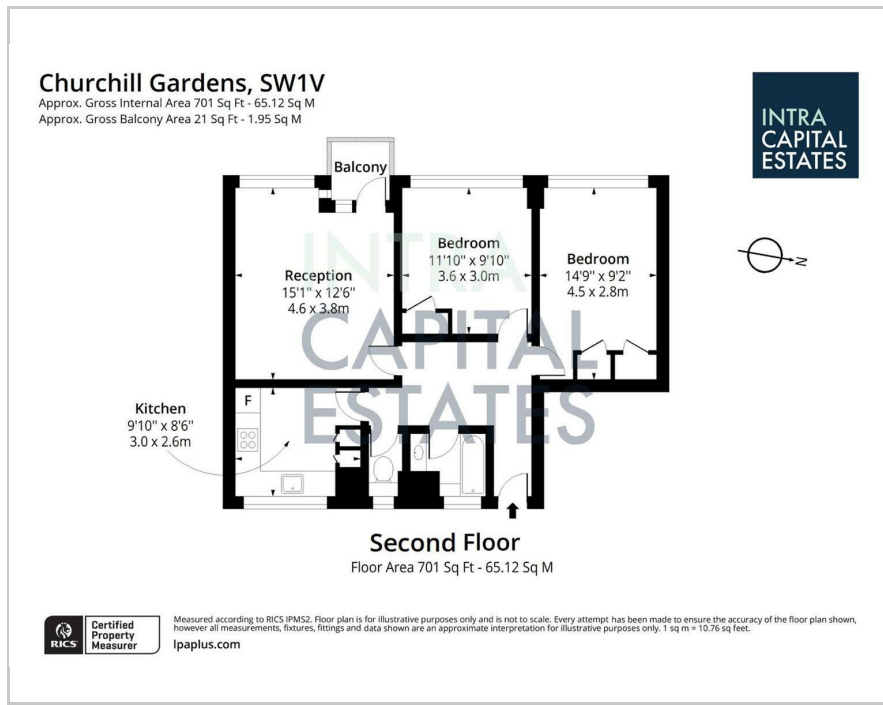

Area Map

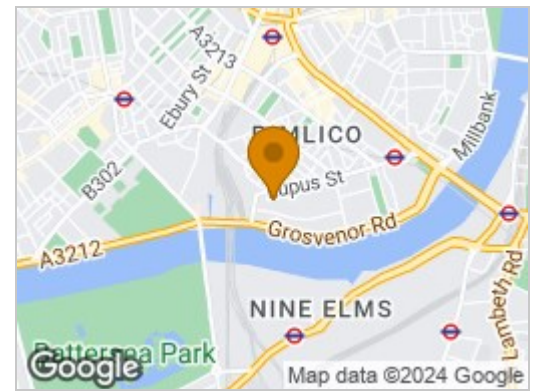

Energy Efficiency Graph

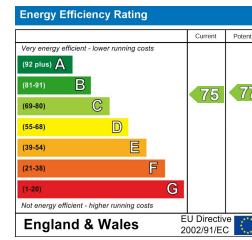

These particulars, whilst believed to be accurate are set out as a general outline only for guidance and do not constitute any part of an offer or contract. Intending purchasers should not rely on them as statements of fact, but must satisfy themselves by inspection or otherwise as to their accuracy. No person in this firm's employment has the authority to make or give any representation or warranty in respect of the property.

INTRA-CAPITAL ESTATES

Paddington Works, 8 Hermitage Street, London, W2 1BE

Tel: 0207 183 6676 Email: info@intra-capital.co.uk

www.intra-capital.co.uk

Intra-Capital Estates is a trading name of Intra Capital Estates Limited, a private limited company registered in England and Wales.
 Registered number: 11840427. VAT registration number: 31763281. Registered office Paddington Works, 8 Hermitage Street, London, W2 1BE.

MODERN APPROACH TRADITIONAL VALUES

