



## Blomfield Villas , London, W2

**£3,750 Per month**

Three double bedroom flat situated in a fantastic location conveniently located close to both Little Venice and Paddington, W2. Set within a beautiful period building the accommodation comprises of an entrance hallway, three double bedrooms, spacious living room, eat in kitchen, WC, and bathroom. Benefits include gas central heating, spacious living throughout as well as characterful features such as high ceilings, original fireplace, and sash windows you would expect of a property from this era.

Ideally situated close to transport links with Warwick Avenue tube station (Bakerloo line) being very close by as well as buses giving you access to Oxford Street, Regent Street and Piccadilly Circus. Conveniently there are also local shops nearby on both Formosa Street and Clifton Gardens.

Available: 17th July 2025  
Minimum initial term: 12 months  
Deposit Required: 5 weeks  
Local Authority: Westminster

- Three Double Bedrooms
- Beautiful Building
- Close to Little Venice and Paddington
- Part Furnished
- Gas Central Heating
- Second Floor
- Characterful Features

### Viewing

Please contact our Intra Capital Estates Office on 0207 183 6676 if you wish to arrange a viewing appointment for this property or require further information.





Floor Plan

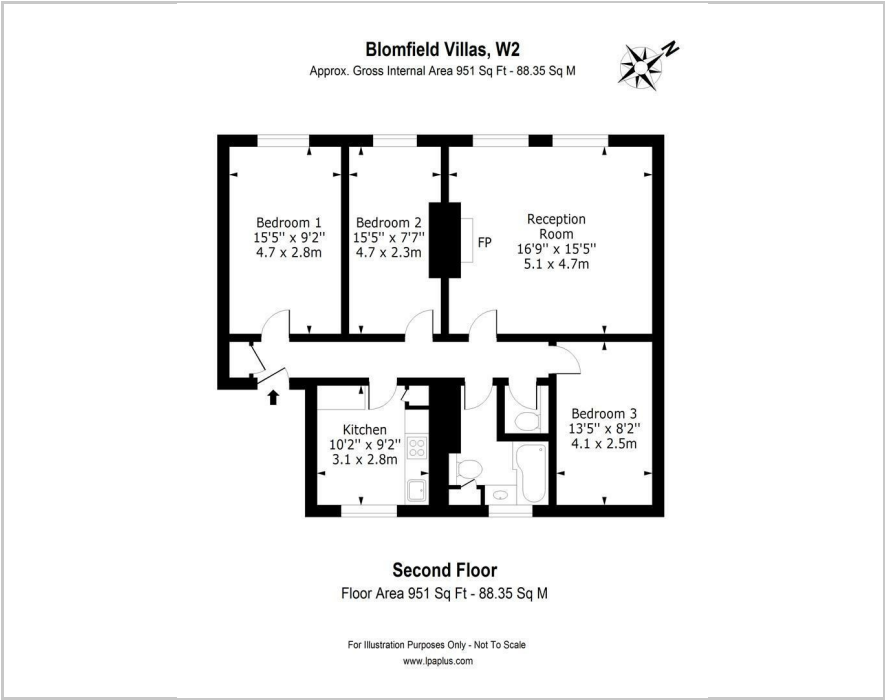

Area Map



Energy Efficiency Graph

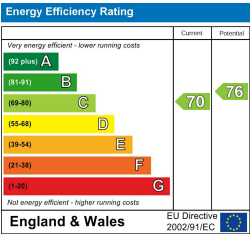

These particulars, whilst believed to be accurate are set out as a general outline only for guidance and do not constitute any part of an offer or contract. Intending purchasers should not rely on them as statements of representation of fact, but must satisfy themselves by inspection or otherwise as to their accuracy. No person in this firm's employment has the authority to make or give any representation or warranty in respect of the property.

INTRA-CAPITAL ESTATES

Paddington Works, 8 Hermitage Street, London, W2 1BE  
Tel: 0207 183 6676 Email: info@intra-capital.co.uk  
www.intra-capital.co.uk

Intra-Capital Estates is a trading name of Intra Capital Estates Limited, a private limited company registered in England and Wales.  
Registered number: 11840427. VAT registration number: 31763281. Registered office Paddington Works, 8 Hermitage Street, London, W2 1BE.

MODERN APPROACH  
TRADITIONAL VALUES

