



## Bourne Terrace , London, W2

**Offers in the region of £555,000**

Nestled in the charming area of Bourne Terrace, W2, this delightful apartment offers a perfect blend of comfort and convenience. Spanning an impressive 797 square feet, the property features three well-proportioned bedrooms, making it an ideal choice for families or those seeking extra space. The single reception room provides a welcoming area for relaxation and entertaining, while the bathroom is thoughtfully designed to cater to your daily needs.

Constructed in 1974, this apartment boasts a timeless appeal, complemented by its proximity to the picturesque Little Venice, known for its serene canals and vibrant community. Just a short stroll away, you will find the bustling amenities of Paddington Basin, where a variety of shops, cafes, and restaurants await to enhance your lifestyle.

This property presents an excellent opportunity for those looking to immerse themselves in a lively yet tranquil neighbourhood, with easy access to transport links and local attractions. Whether you are seeking a new home or a sound investment, this apartment in Bourne Terrace is sure to impress.

- Three Double Bedroom Apartment
- Short walk to Little Venice
- No Onward Chain
- Balcony
- Spacious Reception Room

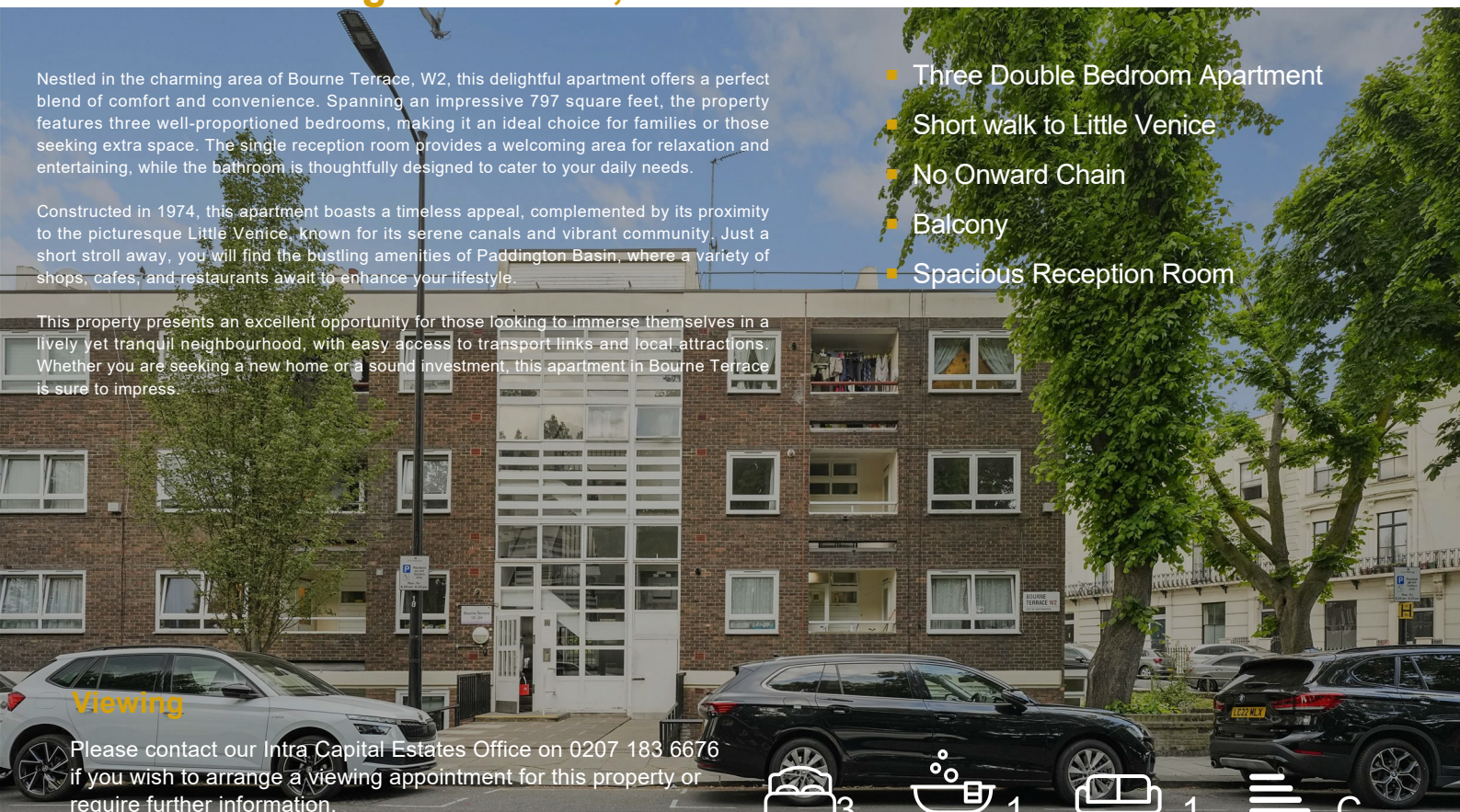

**Viewing**

Please contact our Intra Capital Estates Office on 0207 183 6676 if you wish to arrange a viewing appointment for this property or require further information.



Floor Plan

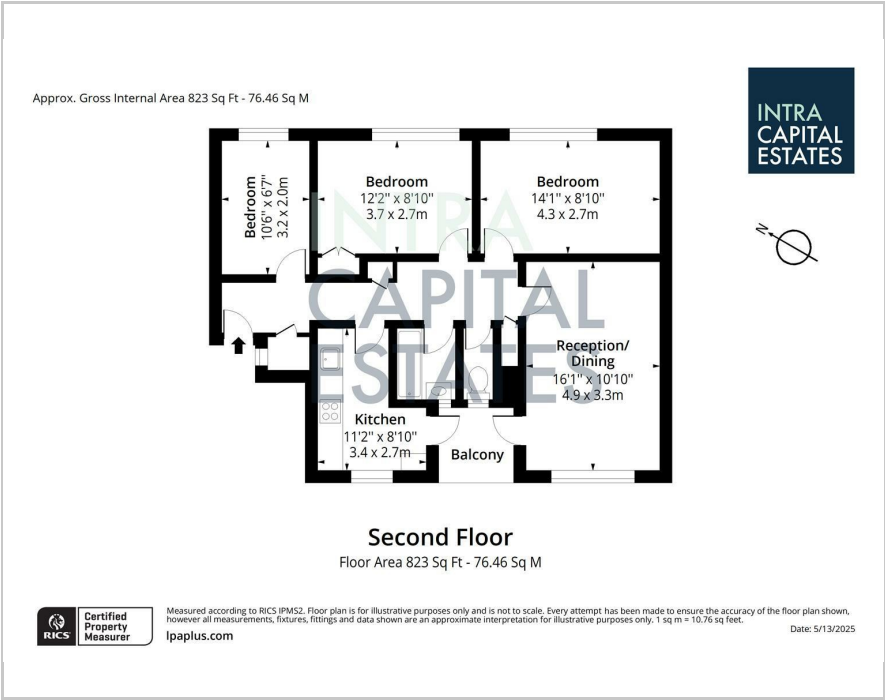

Area Map



Energy Efficiency Graph

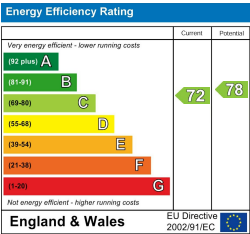

These particulars, whilst believed to be accurate are set out as a general outline only for guidance and do not constitute any part of an offer or contract. Intending purchasers should not rely on them as statements of representation of fact, but must satisfy themselves by inspection or otherwise as to their accuracy. No person in this firm's employment has the authority to make or give any representation or warranty in respect of the property.

INTRA-CAPITAL ESTATES

Paddington Works, 8 Hermitage Street, London, W2 1BE  
Tel: 0207 183 6676 Email: info@intra-capital.co.uk  
www.intra-capital.co.uk

Intra-Capital Estates is a trading name of Intra Capital Estates Limited, a private limited company registered in England and Wales.  
Registered number: 11840427. VAT registration number: 31763281. Registered office Paddington Works, 8 Hermitage Street, London, W2 1BE.

MODERN APPROACH  
TRADITIONAL VALUES

