



# Honeyman Close

London, NW6

**Asking price £1,350,000**

Elegant Four -Bedroom Home in Exclusive Gated Development. Nestled in a prestigious gated enclave, this distinguished four-bedroom terraced residence offers an impressive 1,834 sq. ft. of well designed living space. Thoughtfully extended and enhanced by the current owner, the home now boasts a rear extension and a loft room, creating a versatile and modern family retreat.

Residents enjoy access to amenities, including a leisure complex with swimming pool, sauna, and gym, elevating the lifestyle within this sought-after development. Convenience is enhanced by the benefit of a porter available from 8am to 4pm. Ideally situated in NW6, the property benefits from excellent transport links, highly regarded schools, and an abundance of local amenities. (service charges for leisure complex, grounds maintenance and porter: £3300pa to be confirmed)

Borough: Brent  
Council Tax: Band G  
Tenure: Freehold

- Four Bedrooms
- Two Reception Rooms
- Two Bathrooms
- Gated Development
- Porter
- Leisure Complex with Pool, Gym, Sauna & Jacuzzi
- Convenient Location
- Parking
- No Chain

## Viewing

Please contact our Intra Capital Estates Office on 0207 183 6676 if you wish to arrange a viewing appointment for this property or require further information.





Floor Plan

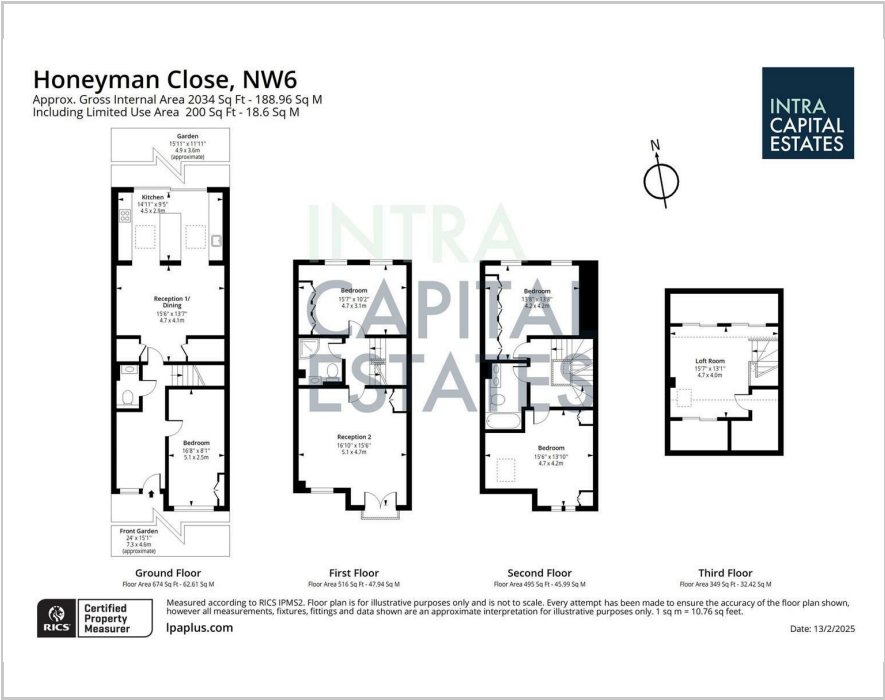

Area Map



Energy Efficiency Graph

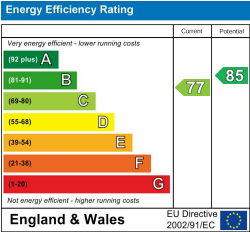

These particulars, whilst believed to be accurate are set out as a general outline only for guidance and do not constitute any part of an offer or contract. Intending purchasers should not rely on them as statements of representation of fact, but must satisfy themselves by inspection or otherwise as to their accuracy. No person in this firms employment has the authority to make or give any representation or warranty in respect of the property.

INTRA-CAPITAL ESTATES

Paddington Works, 8 Hermitage Street, London, W2 1BE  
Tel: 0207 183 6676 Email: info@intra-capital.co.uk  
www.intra-capital.co.uk

Intra-Capital Estates is a trading name of Intra Capital Estates Limited, a private limited company registered in England and Wales.  
Registered number: 11840427. VAT registration number: 31763281. Registered office Paddington Works, 8 Hermitage Street, London, W2 1BE.

MODERN APPROACH  
TRADITIONAL VALUES

