



Churchill Gardens

London, SW1V

Offers in the region of £470,000

Two double bedroom apartment situated within the popular Churchill Gardens Estate in SW1V. Keats House is one of the buildings on the edge of the development and boasting views of the River Thames. Accessed from the first floor, the accommodation is arranged over approx. 683 sq ft and comprises of an entrance hallway, WC, kitchen, living room, 2 double bedrooms and a bathroom. There is also a large balcony which can be accessed from both the living room and kitchen which boast some nice side views across gardens and the River Thames. The property is in need of modernisation but in our opinion offers the next purchaser a blank canvas to put their own stamp on. Building with lift. No chain.

- Two Bedroom Apartment
- First Floor (Building with Lift)
- Situated on Outskirts of Churchill Gardens Estate
- In Need of Modernisation
- Large Balcony with Side River Views
- No Onward Chain

Viewing

Please contact our Intra Capital Estates Office on 0207 183 6676 if you wish to arrange a viewing appointment for this property or require further information.



Floor Plan

Keats House, SW1V

Approx. Gross Internal Area 683 Sq Ft - 63.45 Sq M
Approx. Gross Balcony Area 78 Sq Ft - 7.25 Sq M

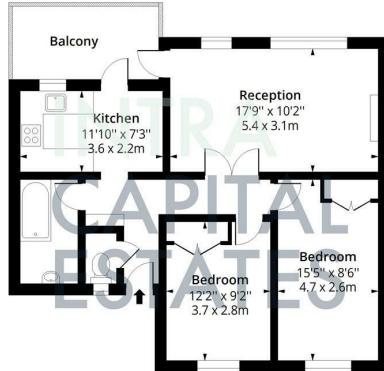

First Floor

Floor Area 683 Sq Ft - 63.45 Sq M



Measured according to RICS IPMS2. Floor plan is for illustrative purposes only and is not to scale. Every attempt has been made to ensure the accuracy of the floor plan shown, however all measurements, fixtures, fittings and data shown are an approximate interpretation for illustrative purposes only. 1 sq m = 10.76 sq feet.

Date: 5/9/2024

INTRA
CAPITAL
ESTATES



Area Map

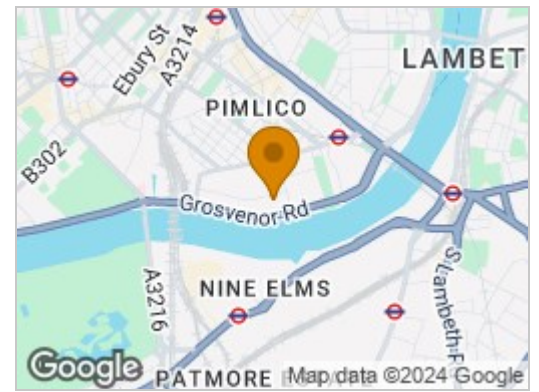

Energy Efficiency Graph

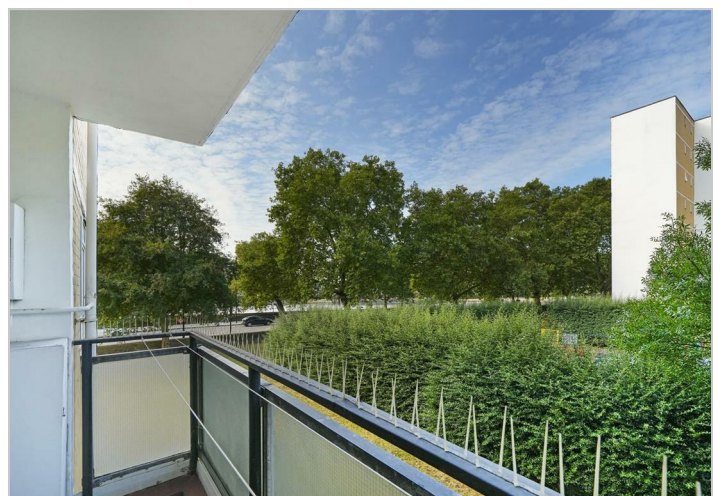
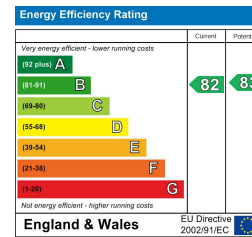

These particulars, whilst believed to be accurate are set out as a general outline only for guidance and do not constitute any part of an offer or contract. Intending purchasers should not rely on them as statements of representation of fact, but must satisfy themselves by inspection or otherwise as to their accuracy. No person in this firm's employment has the authority to make or give any representation or warranty in respect of the property.

INTRA-CAPITAL ESTATES

Paddington Works, 8 Hermitage Street, London, W2 1BE

Tel: 0207 183 6676 Email: info@intra-capital.co.uk

www.intra-capital.co.uk

Intra-Capital Estates is a trading name of Intra Capital Estates Limited, a private limited company registered in England and Wales.
Registered number: 11840427. VAT registration number: 31763281. Registered office Paddington Works, 8 Hermitage Street, London, W2 1BE.

MODERN APPROACH TRADITIONAL VALUES

