

C JAMES & CO - TOOTING

SALES AND LETTINGS SPECIALISTS



Flat First Floor, 20 Pendle Road, London, SW16 6RU

Offers in the region of £450,000

Situated in a lovely period building this generous sized two bedroom conversion flat is being offered to the market with no onward chain.

Tastefully decorated with a wealth of original features, coupled with contemporary décor and modern kitchen and bathroom this home blends the best of old and new.

Located in the leafy Furzedown area, it is close to Tooting Bec Common and Lido and within walking distance of Tooting town centre and all the transport facilities it has to offer.

Very close by is the popular Moyser Road area with its artisan shops and pavement cafes. This property is an ideal first purchase and would make a lovely home.

Floor Plan

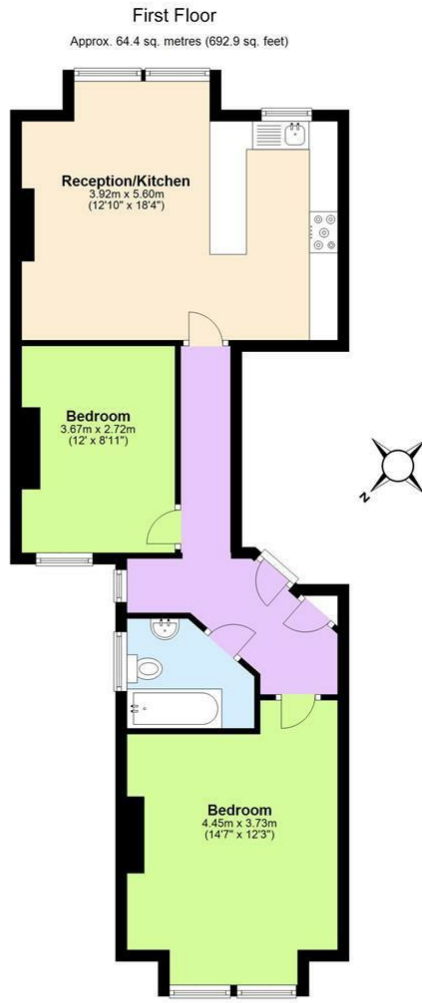

Total area: approx. 64.4 sq. metres (692.9 sq. feet)

Disclaimer: Please note this floor plan is for marketing purposes and is to be used as a guide only. Plan produced using PlanUp.

Area Map

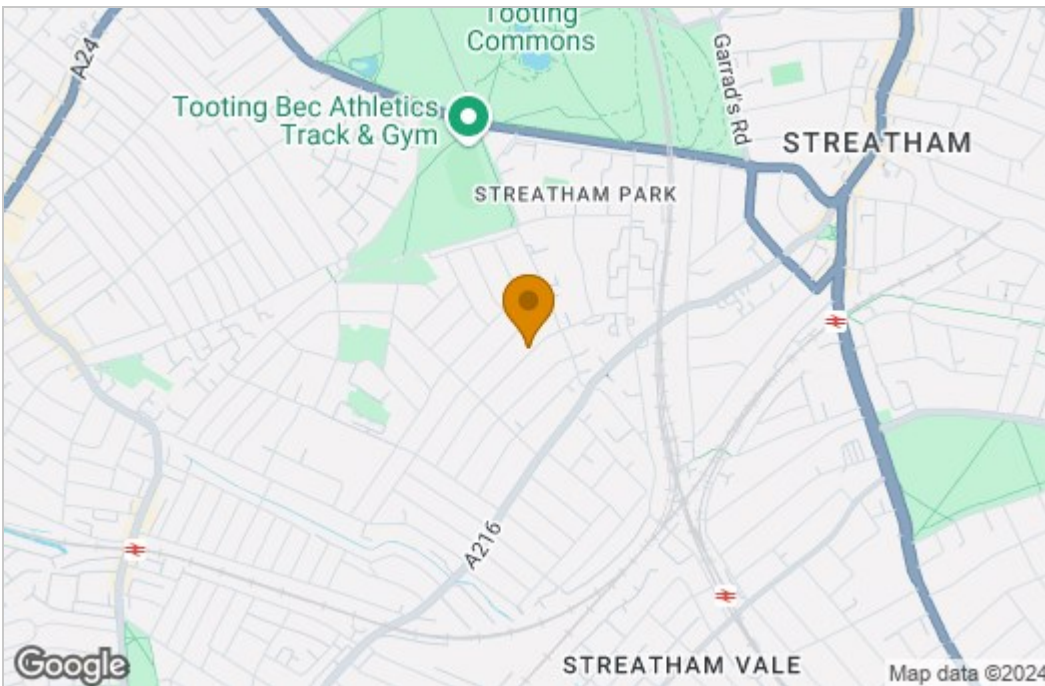

Energy Efficiency Graph

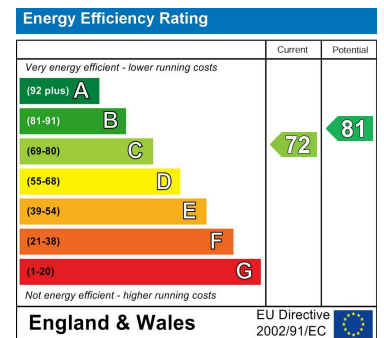

These particulars, whilst believed to be accurate are set out as a general outline only for guidance and do not constitute any part of an offer or contract. Intending purchasers should not rely on them as statements of representation of fact, but must satisfy themselves by inspection or otherwise as to their accuracy. No person in this firm's employment has the authority to make or give any representation or warranty in respect of the property.