

C JAMES & CO - TOOTING

SALES AND LETTINGS SPECIALISTS



St Georges Court 209-213 Tooting High Street, Tooting, SW17 0SZ **£285,000**

Offered for sale is this well presented second floor one bedroom flat.

Located in a well maintained small block this property is conveniently placed for both Tooting over ground Thames Link Station and Tooting Broadway tube station. St George's Hospital is also very close.

This property would in my opinion make an excellent first purchase or even a buy to let investment.

Floor Plan

Second Floor

Approx. 38.0 sq. metres (409.5 sq. feet)

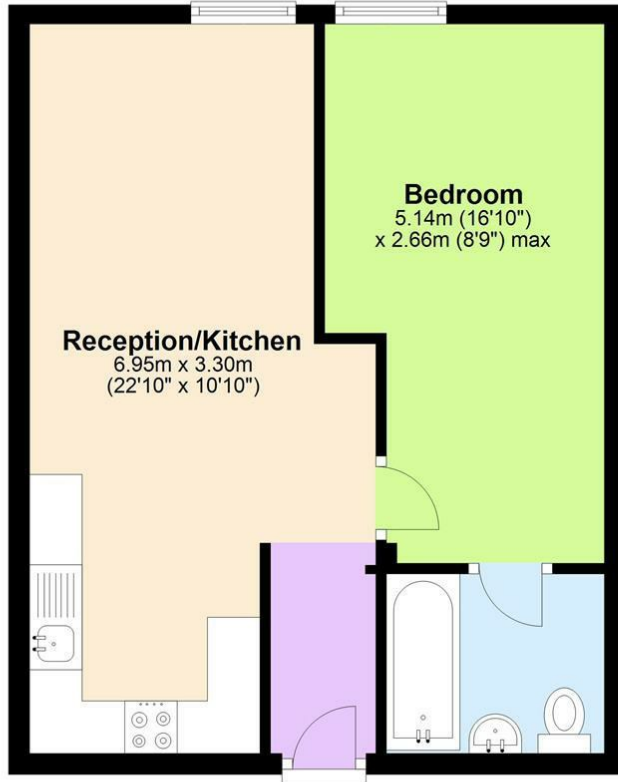

Total area: approx. 38.0 sq. metres (409.5 sq. feet)

Disclaimer: Please note this floor plan is for marketing purposes and is to be used as a guide only.
Plan produced using PlanUp.

Area Map

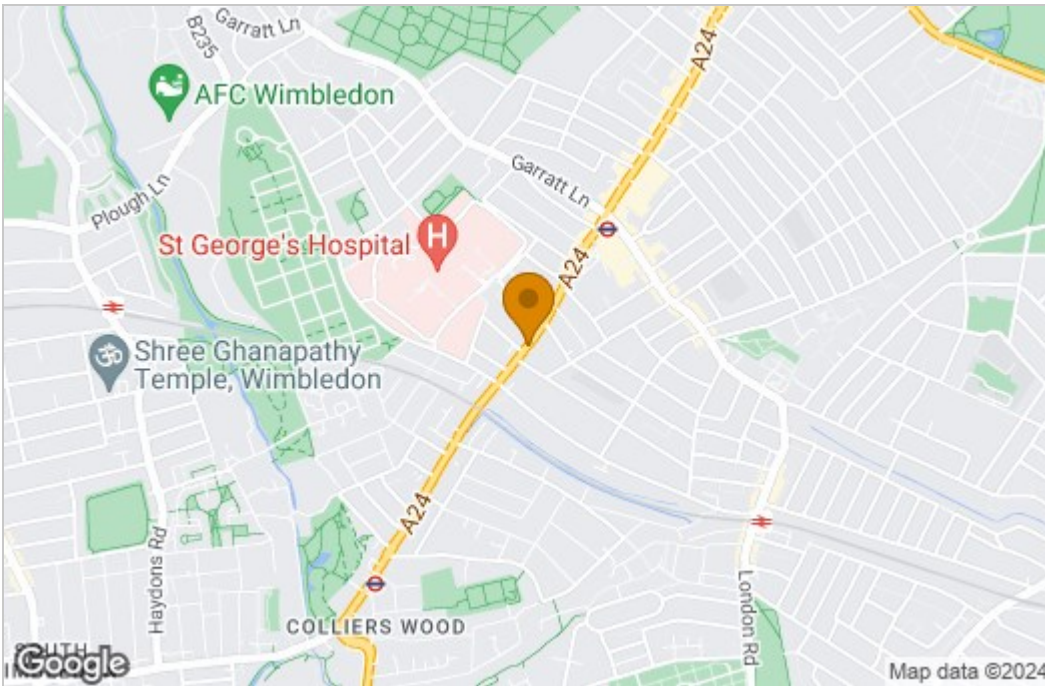

Energy Efficiency Graph

Energy Efficiency Rating		Current	Potential
Very energy efficient - lower running costs			
(92 plus) A			
(81-91) B			
(69-80) C		72	77
(55-68) D			
(39-54) E			
(21-38) F			
(1-20) G			
Not energy efficient - higher running costs			
England & Wales		EU Directive 2002/91/EC	

These particulars, whilst believed to be accurate are set out as a general outline only for guidance and do not constitute any part of an offer or contract. Intending purchasers should not rely on them as statements of representation of fact, but must satisfy themselves by inspection or otherwise as to their accuracy. No person in this firm's employment has the authority to make or give any representation or warranty in respect of the property.