



**Unit 7 Poole Industrial Estate
Wellington
Somerset
TA21 9HH**

Detached industrial unit to let

G.I.A of 314.07 sq m (3,379 sq ft)

- Popular industrial estate 2 miles from J26 of the M5.
- Warehouse including two-storey office block.
- Concrete yard to front with parking for 10/12 vehicles.
- Additional yard area to side with parking for 20/25 vehicles.

LOCATION

The industrial unit is located at Poole Industrial Estate on the edge of Wellington and located 2 miles from J26 of the M5 motorway.

DESCRIPTION

Detached industrial unit with a Gross Internal Area of 24.03m x 13.07m = 314.07 sq m (3,379 sq ft).

Warehouse of 16.74m x 13.07m accessed via an electric roller shutter door with a width of 5.82m and a height of 4.29m. Concrete floor, 3-phase electricity and LED low-bay lighting. Minimum eave height of 6.27m and a maximum eave height of 7.98m.

The industrial unit includes a two-storey office block with entrance lobby with stairs to first floor offices and WC facilities including cloakroom and disabled WC.

Ground floor:-

Office 1 of 8.30m x 2.31m leading through into the kitchen of 4.39m x 3.55m. From the kitchen there is a door into the warehouse.

Office 2 of 3.84m x 3.45m with windows overlooking the warehouse.

First floor:-

Office 3 of 12.82m x 3.42m.

Office 4 of 4.09m x 3.55m.

Office 5 of 3.66m x 3.66m with windows overlooking the warehouse.

Office 6 of 3.66m x 3.56m.

The offices have LED lighting and trunking.

Outside:-

Front yard laid to asphalt with parking for 10/12 vehicles and a further side yard laid to asphalt which could easily be gated for security purposes with parking for a further 20/25 vehicles.

TENURE & RENTAL

New lease available on flexible terms to be agreed at a quoting rent of £26,000 per annum plus VAT.

EPC

EPC rating: E

ACCOMMODATION

The property has been measured on a Gross Internal Area basis in accordance with the RICS Code of Measuring Practice the floor areas calculated are noted below:

	Sq m	Sq ft
<i>Ground floor</i>		
Warehouse	218.79	2355
Office 1	19.17	206
Kitchen	15.58	168
Office 2	13.25	143
<i>First floor</i>		
Office 3	43.84	472
Office 4	14.52	156
Office 5	13.40	144
Office 6	13.03	140

BUSINESS RATES

According to the Valuation Office website, the premises are assessed as the following:

Rateable value: £26,500

For verification purposes, interested parties are advised to make their own enquiries at www.vo.gov.uk.

VIEWING

All viewings should be made through the sole agent, Carter Jonas

T: 01823 428590

M: 07968 216596

E: Stephen.richards@carterjonas.co.uk.

LEGAL COSTS

Each party to bear their own legal costs throughout the transaction.



SUBJECT TO CONTRACT

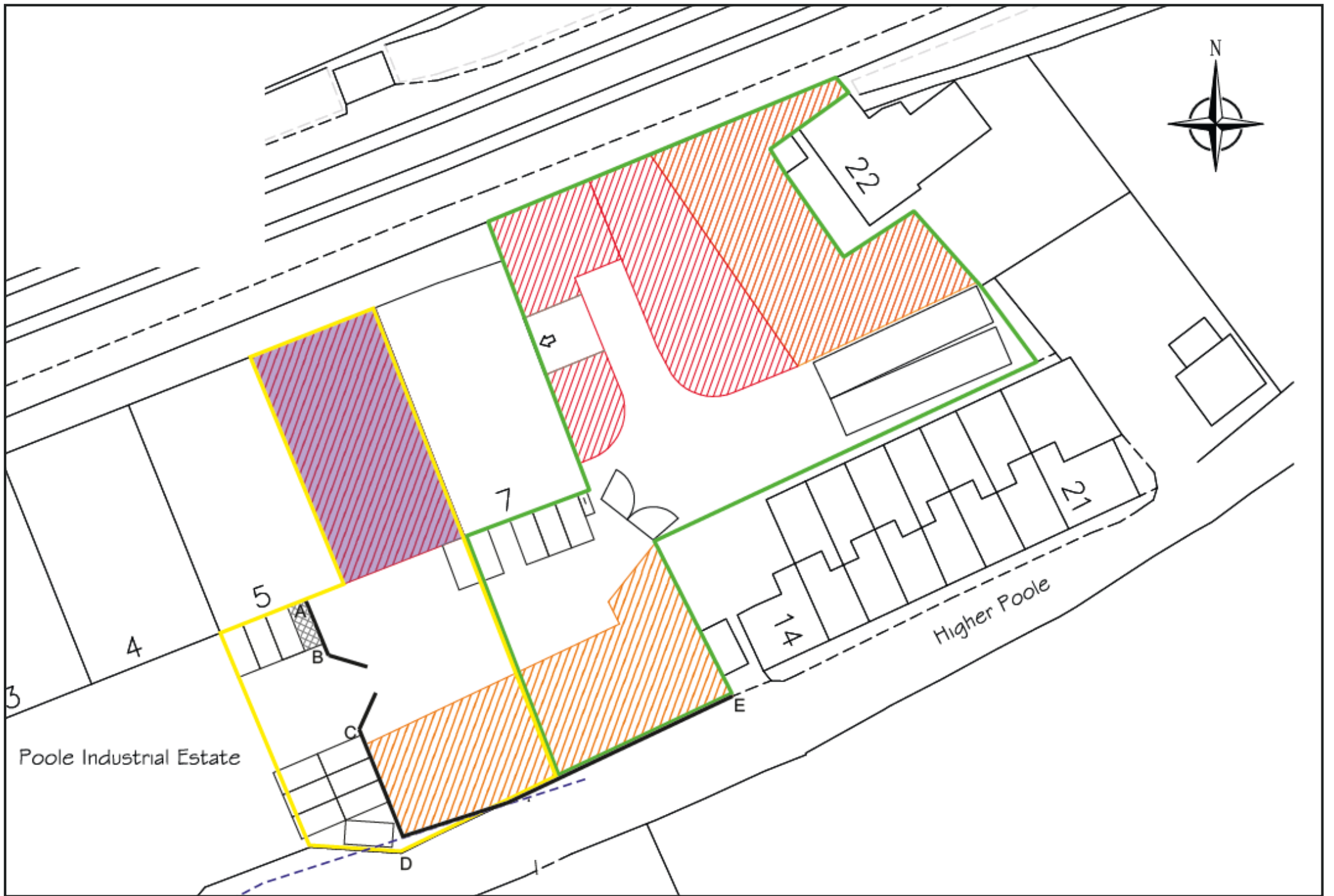

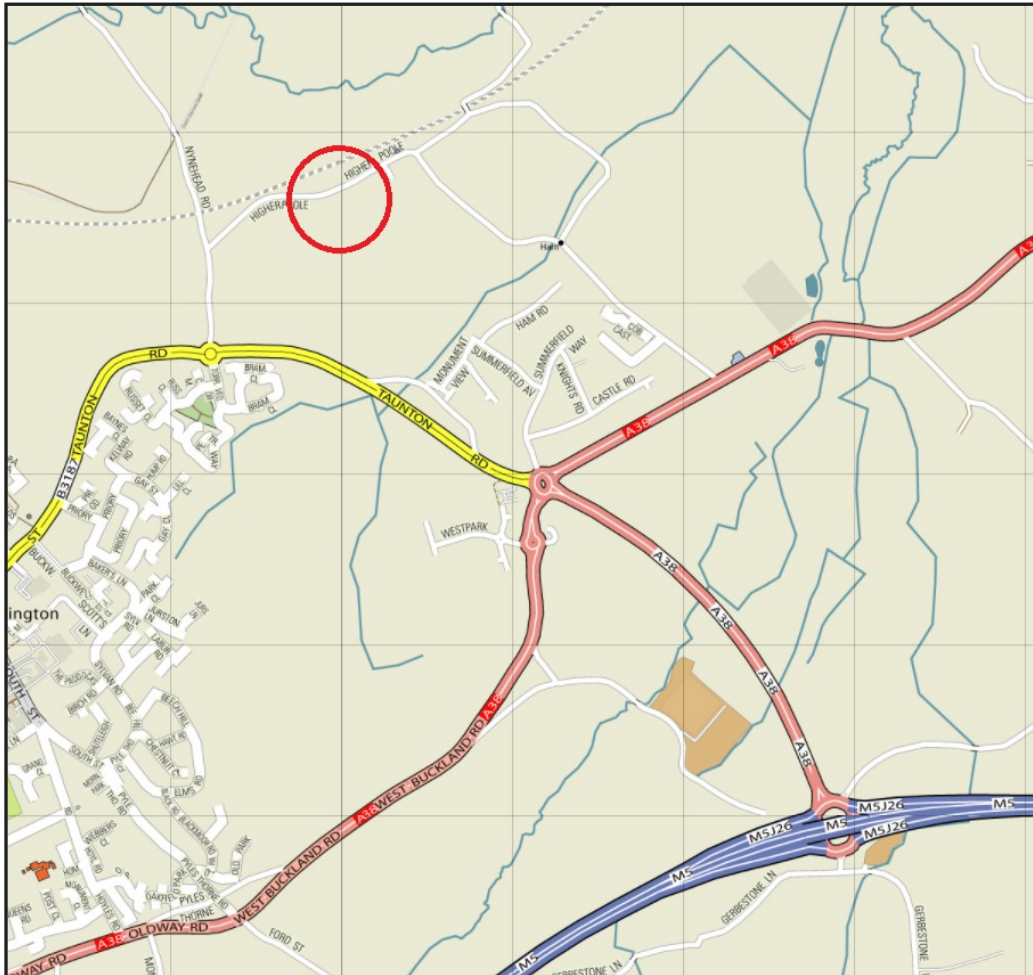

FURTHER INFORMATION

Should you require further information please contact Stephen Richards.

carterjonas.co.uk

Stephen Richards MRICS

M: 07968 216596 | T: 01823 428590

E: Stephen.richards@carterjonas.co.uk

Quad 4000, Blackbrook Park Ave, Taunton, Somerset, TA1 2PX

IMPORTANT INFORMATION

These particulars are for general information purposes only and do not represent an offer of contract or part of one. Carter Jonas has made every attempt to ensure that the particulars and other information provided are as accurate as possible and are not intended to amount to advice on which you should rely as being factually accurate. You should not assume that the property has all necessary planning, building regulations or other consents and Carter Jonas have not tested any services, facilities or equipment. Any measurements and distances given are approximate only. Purchasers must satisfy themselves of all of the aforementioned by independent inspection or otherwise. Although we make reasonable efforts to update our information, neither Carter Jonas LLP nor anyone in its employment or acting on its behalf makes any representations warranties or guarantees, whether express or implied, in relation to the property, or that the content in these particulars is accurate, complete or up to date. Our images only represent part of the property as it appeared at the time they were taken. If you require further information please contact us.

Carter Jonas