

4 Jasmin Close
 Minster On Sea, Sheerness, ME12 3FL
 Offers in excess of £495,000

5 3 2 C

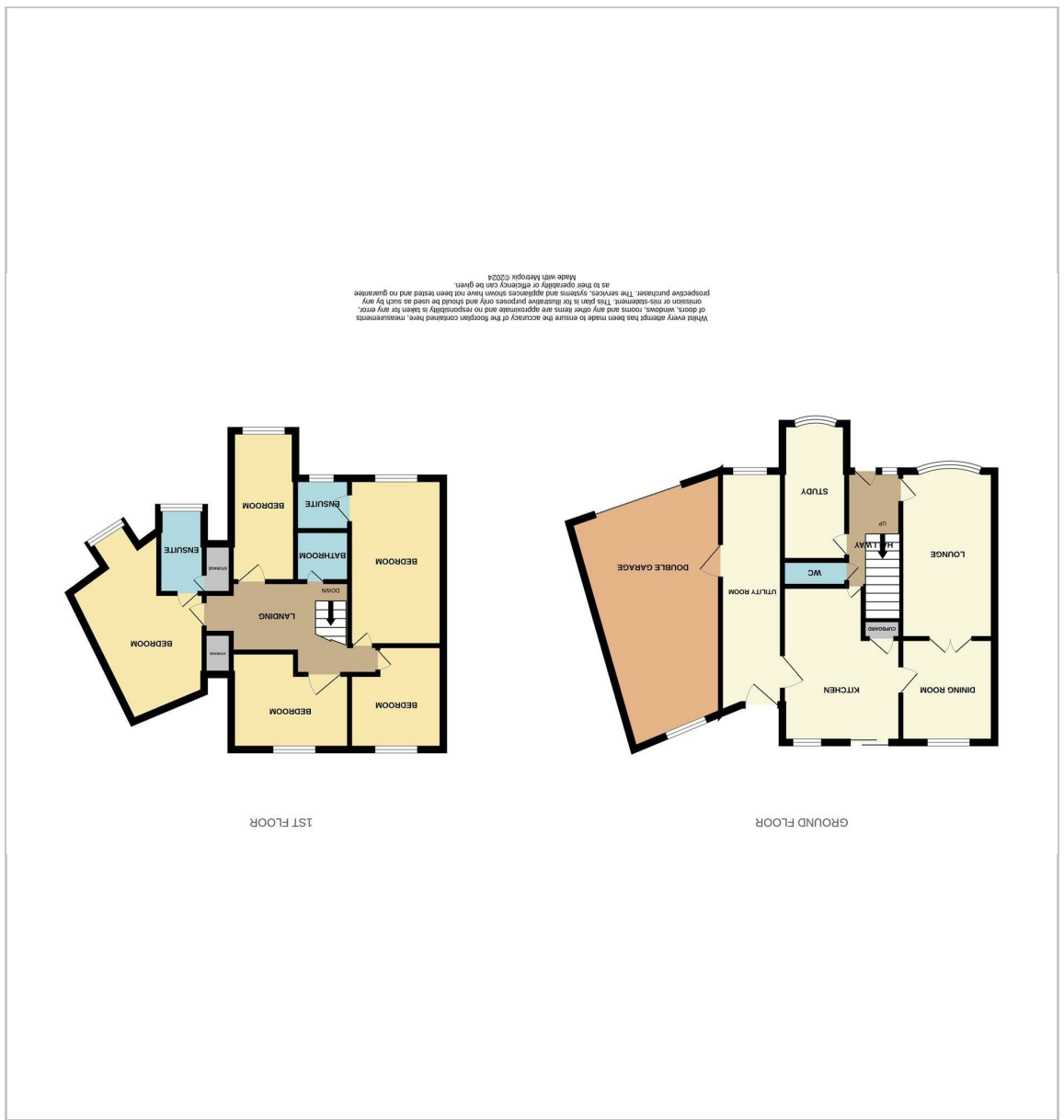

Floor Plan



Area Map

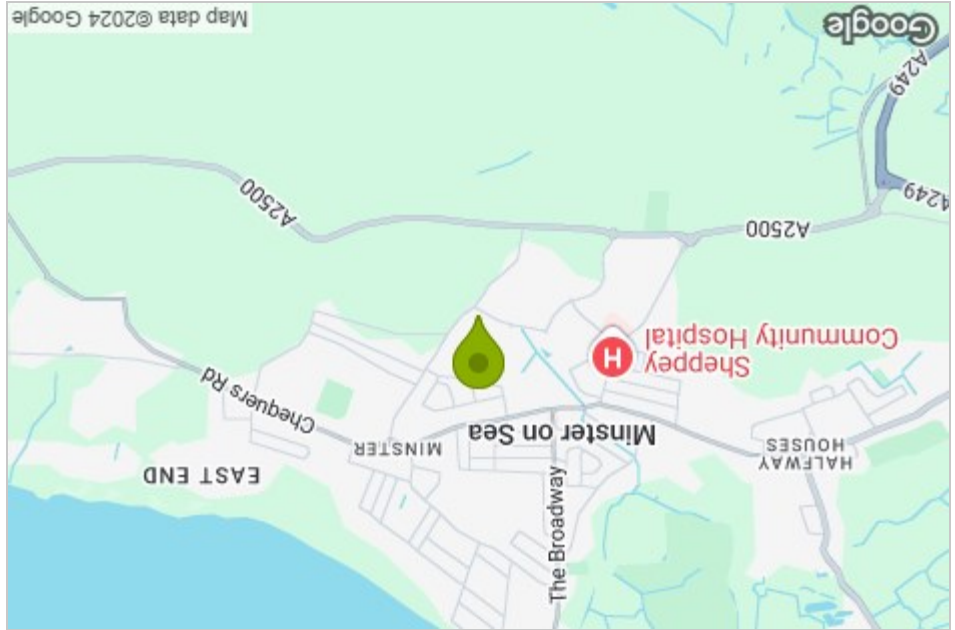

Energy Efficiency Graph

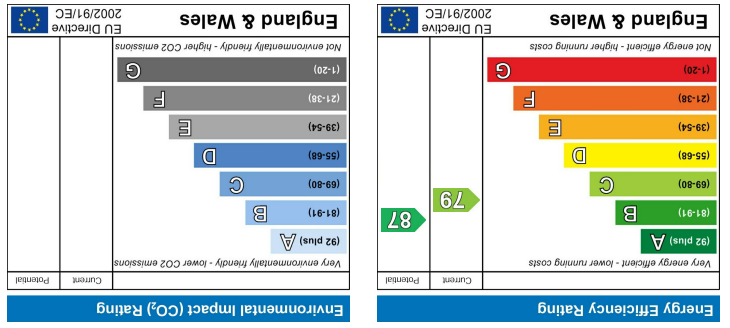

Viewing

Please contact our Isle of Sheppey Office on 01795 666 666 if you wish to arrange a viewing appointment for this property or require further information.

These particulars, whilst believed to be accurate are set out as a general outline only for guidance and do not constitute any part of an offer or contract. Intending purchasers should not rely on them as statements of representation of fact, but must satisfy themselves by inspection or otherwise as to their accuracy. No person in this firm's employment, whilst believed to be accurate are set out as a general outline only for guidance and do not constitute any part of an offer or contract.

4 Jasmin Close



- 5 Bed Linked Detached House
- 2 Reception Rooms plus Study
- Main Bathroom & En -Suites
- Close To Local Amenities
- Separate Utility Area
- Low Maintenance Garden
- Modern Kitchen
- Short Walk To Schools
- Double Garage
- Viewings Highly Recommended

Description

James Perry welcome you to Jasmin Close, Minster On Sea, Sheerness - a delightful location for this 5 bed house that is sure to capture your heart. You have off road parking for four cars so parking isn't a problem. This property boasts not just one, but two ensuite and a family bathroom, offering you the luxury and convenience you deserve. Plus main bathroom & downstairs WC.

As you step inside, you'll be greeted by two good size reception rooms and a open plan kitchen diner with integral appliances, you also have the benefit from a large utility room, perfect for all your storage and laundry needs. The double garage provides ample space for your vehicles or can be transformed into a workshop or hobby area - the possibilities are endless.

The low maintenance garden is a tranquil oasis where you can unwind after a long day or entertain guests with ease. Imagine enjoying a cup of tea or hosting a barbecue in this lovely outdoor space.

This house is in "just move in" condition, meaning you can start creating memories from day one without the hassle of renovations or repairs. Don't miss out on this fantastic opportunity to make this house your home. Jasmin Close is calling - will you answer?

Minster On Sea, Sheerness, ME12 3FL

