

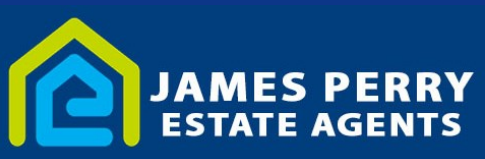

1A Waterloo Hill Union Road
 Minster On Sea, Sheerness, ME12 2HW
 Offers in the region of £367,500

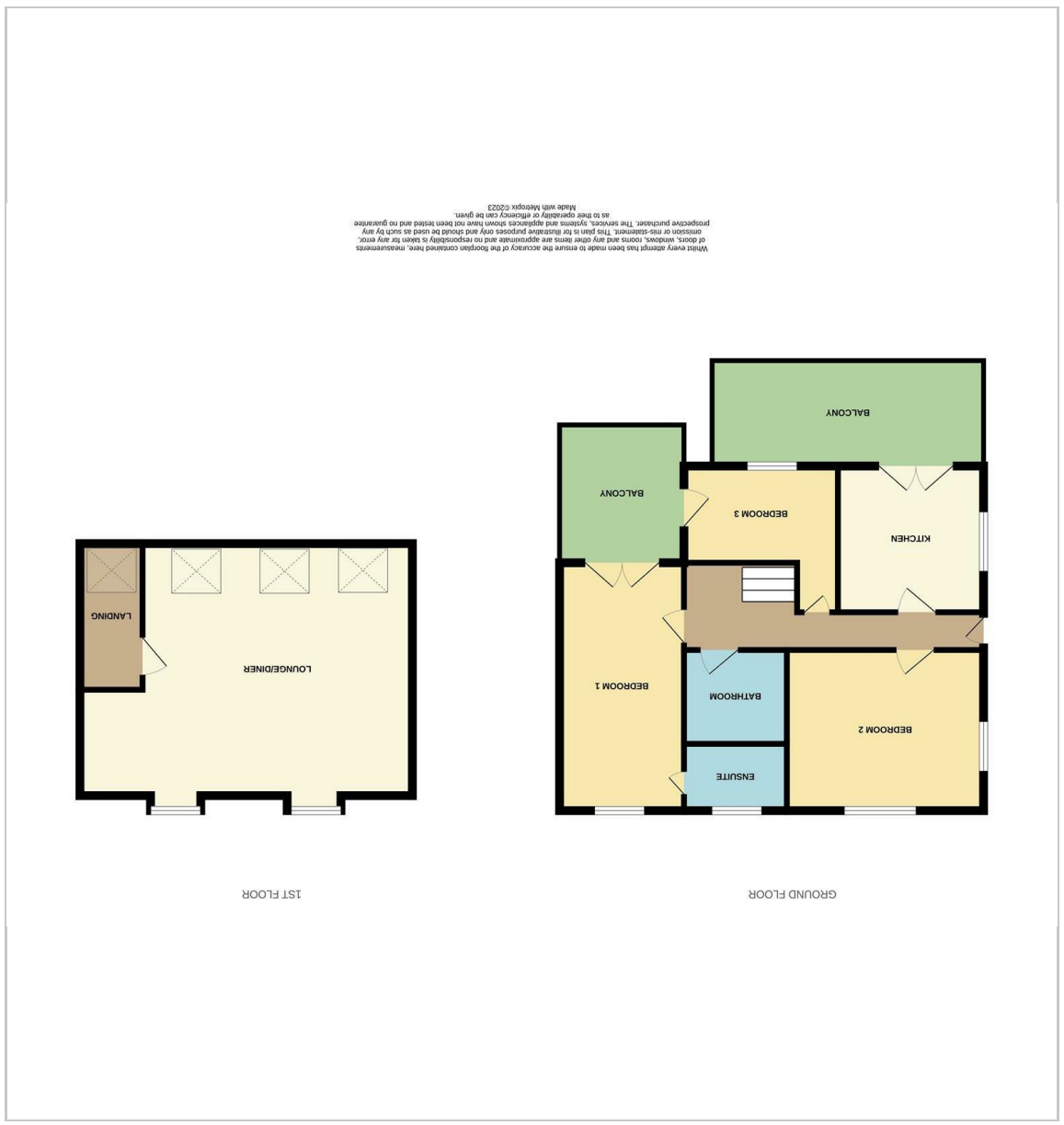

Floor Plan



Area Map



Energy Efficiency Graph

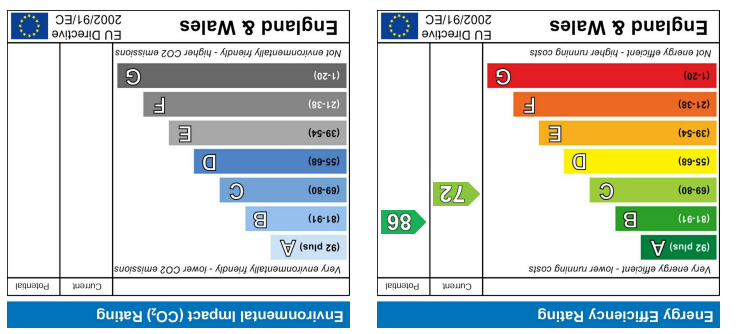

Viewing

Please contact our Isle of Sheppey Office on 01795 666 666 if you wish to arrange a viewing appointment for this property or require further information.

These particulars, whilst believed to be accurate are set out as a general outline only for guidance and do not constitute any part of an offer or contract. Intending purchasers should not rely on them as statements of representation or fact, but must satisfy themselves by inspection or otherwise as to their accuracy. No person in this firm's employment has the authority to make or give any representation or warranty in respect of the property.

1A Waterloo Hill Union Road



- VIEWING HIGHLY RECOMMENDED
- BLOCK PAVED PARKING
- DOUBLE GLAZED
- 3 BEDROOMS & LARGE GARDEN
- HEART OF MINSTER VILLAGE
- STUNNING DETACHED PROPERTY
- MASTER BEDROOM ENSUITE
- PANORAMIC VIEWS
- GAS CENTRAL HEATED
- CLOSE TO ALL LOCAL AMENITIES

Description

This property is in the heart of Minster village. Close to the co-op mini supermarket and all minster village amenities including Minster Club, hairdressers, pubs and takeaways.

Breath taking views over the island!. Stunning immaculately presented 3 bed accommodation, It is highly recommended that you should put this detached property at the top of your viewing list!

Internally this property is in exceptional condition with tasteful décor and newly fitted flooring plus brand new kitchen with French doors to full length decked patio. The house benefits from a relaxing upstairs living space. for all entertaining purposes .There is a new white bathroom suite and the gardens have been landscaped. The property has benefit of gas central heating, double glazing and parking for several cars.

A good sized Master Bedroom is truly amazing with en suite and set French doors leading onto a balcony/ patio with panoramic views over the island to the swale. Access is quick and easy off the Island is via lower Road.

Planning approved, ref 22/501351/FULL | Conversion of loft area into a habitable space. With alterations to roof including addition of 1 no. front dormer window. | Island View 1A Waterloo Hill Minster-on-sea Sheerness Kent ME12 2HW

STRICTLY BY APPOINTMENT.ONLY.

Minster On Sea, Sheerness, ME12 2HW

