



2 Floors



4 Bedrooms



Utility



1 En suite



Garage

HALLAM FOUR BEDROOM HOME

A four bedroom detached home featuring a spacious lounge, open plan kitchen / dining / family area with French doors to the rear garden. A utility cupboard and cloakroom complete this floor. Upstairs is home to four bedrooms, two of which are double and the master bedroom boasting fitted wardrobes and en suite shower room.

HALLAM FOUR BEDROOM HOME

◇ DIMENSIONS

First Floor:

Bedroom 1

2.60m x 3.15m
8'6" x 10'4"

En Suite

Bedroom 2

3.57m x 2.45m
11'8" x 8'0"

Bedroom 3

2.03m x 3.15m
6'8" x 10'4"

Bedroom 4

2.56m x 2.28m
8'5" x 7'6"

Bathroom

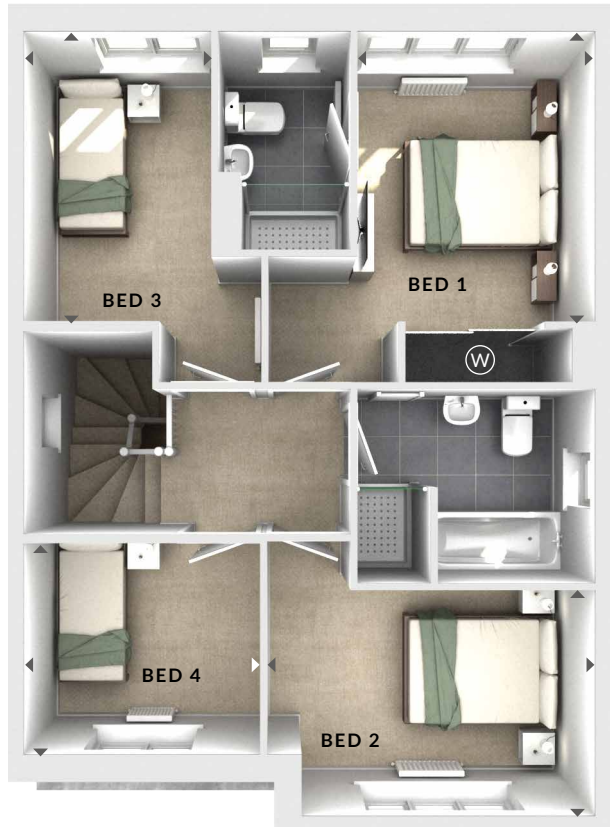

First Floor

Ground Floor:

Lounge

3.35m x 4.64m
11'0" x 15'3"

Kitchen / Dining / Family

6.20m x 3.76m
20'4" x 12'4"

(W) Wardrobes

(U) Utility

(C) Cloaks

◀▶ Measurement Points

△ External Access



Ground Floor

© Bloor Homes
470B 7.0

These particulars are intended as a preliminary guide for prospective purchasers and should not be relied upon. The elevational treatment for individual house types shows a typical arrangement. Details of materials and design treatments may vary. Any artist impressions shown are not intended to represent any particular plot. Purchasers are advised to inspect the layout plan to establish the arrangement of the house and surrounding property. Internal layouts show a general arrangement which may vary from plot to plot. Room sizes given are approx. overall finished room sizes and subject to normal building tolerances (ie ± 75mm). In all instances purchasers are advised to inspect plot specific information available from our sales team. Nothing in these particulars or verbal assurance shall form or constitute part of any contract, and are given without any responsibility on behalf of Bloor Homes.

BLOOR HOMES