

The Cottage, Pool House Mews, Dam Street - Available Now, City Centre Location

£1,200PCM (Deposit: £1,384)

 2  1  1

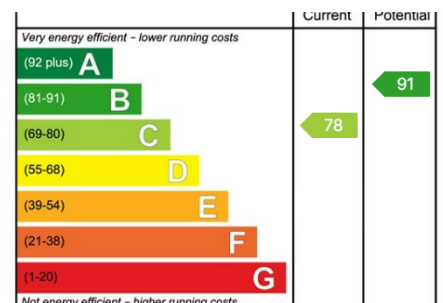

Tax Band: D Furnished: Unfurnished

A beautifully presented two double bedroom cottage-style home, nestled right in the heart of Lichfield's vibrant city centre.

This fabulous home lies moments from the award-winning Beacon Park, Stowe Pool and a host of upmarket bars, restaurants, major supermarkets, Lichfield Cathedral and highly respected schools. Commuting is effortless; Lichfield City station is just a short stroll away for direct

services to Birmingham, while Lichfield Trent Valley - within a short drive - offers a direct link to London.

Blending cottage charm with contemporary excellence and city centre living, this property cannot afford to be missed; book in a viewing at your earliest convenience in order to avoid disappointment.

Key Features

- Two Double Bedroom Cottage-Style Home
- Available Now
- Nestled Right In The Heart Of Lichfield's Vibrant City Centre
- Secure Parking
- Fob-Controlled Vehicular Gates
- Porcelanosa Shower Room
- EPC Rating: C
- Council Tax Band: D
-
-

Approx Gross Internal Area
67 sq m / 726 sq ft

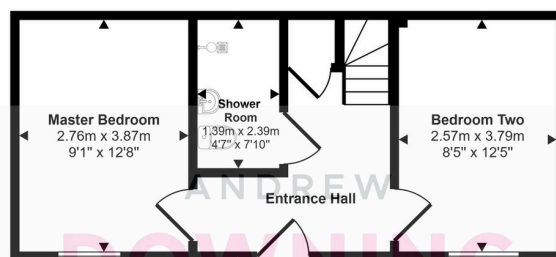

Ground Floor
Approx 34 sq m / 363 sq ft

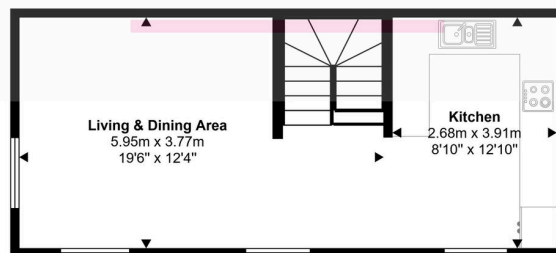

First Floor
Approx 34 sq m / 363 sq ft

This floorplan is only for illustrative purposes and is not to scale. Measurements of rooms, doors, windows, and any items are approximate and no responsibility is taken for any error, omission or mis-statement. Icons of items such as bathroom suites are representations only and may not look like the real items. Made with Made Snappy 360.