



Upper St. John's Street Lichfield, WS14 9DT - Brand New City Centre Apartment

£245,000

🛏 2 🍳 1 🚿 1



A Superb opportunity for any first time buyers, investors or downsizers! A number of newly renovated, high specification & stylish two bedroom apartments in a heritage building located in the heart of Lichfield. Magnificent renovation works have been undertaken within this stunning building to bring it back to life, to incorporate a number of stunning original features, whilst the building is positioned with incredible access to Lichfield's vibrant city centre, with Lichfield City Station sitting just around the corner. Alongside the wonderful period features, each apartment will offer a modern open plan lounge and kitchen area, two double bedrooms and contemporary bathroom. There will be an allocated parking space per apartment and the finish will be nothing short of spectacular.

The accommodation comprises an entrance hall, an open-plan kitchen/living area, two spacious double bedrooms with ample built-in storage, and a contemporary-style family bathroom.

Contact us today to arrange your viewing on this fabulous apartment.



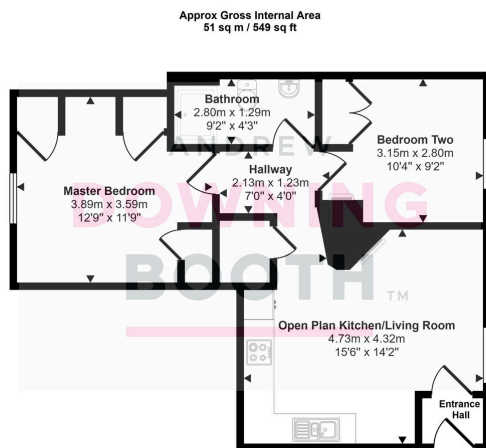

Floorplan

This floorplan is only for illustrative purposes and is not to scale. Measurements of rooms, doors, windows, and any items are approximate and no responsibility is taken for any error, omission or mis-statement. Icons of items such as bathroom suites are representations only and may not look like the real items. Made with Made Snappy 360.

- Two Bedroom Apartment
- Fabulous Character Features
- Wonderful Position Close To The City Centre & City Station
- One Allocated Parking Space
- High Specification Throughout
- Call Today To Book A Visit Of Our Show Apartment

