





# Dominium Court, Wade Street, Lichfield, WS13 6HT - City Centre Location

£250,000

🛏 2 🚿 2 🛋 1





Situated in the heart of Lichfield, Dominion Court on Wade Street presents a sought-after development with the added convenience of lifts to all floors.

Dominion Court enjoys an desirable position on Wade Street, right in the heart of Lichfield city centre. Residents benefit from a wealth of amenities on the doorstep, including an excellent selection of shops, cafés, restaurants and leisure facilities, all within easy walking distance. The city's historic attractions and beautiful parks are also close by, alongside Lichfield City and Trent Valley train stations offering direct links to Birmingham and London. Families will appreciate the choice of highly regarded local schools, both primary and secondary, making this an attractive location for professionals and families alike.

The accommodation is arranged across one floor and features a welcoming entrance hall leading into a spacious open plan living, dining and kitchen area. The property further offers a master bedroom with ensuite shower room, a second well-proportioned bedroom and a contemporary family bathroom.

An early viewing is highly recommended to fully appreciate the style and convenience this property offers.



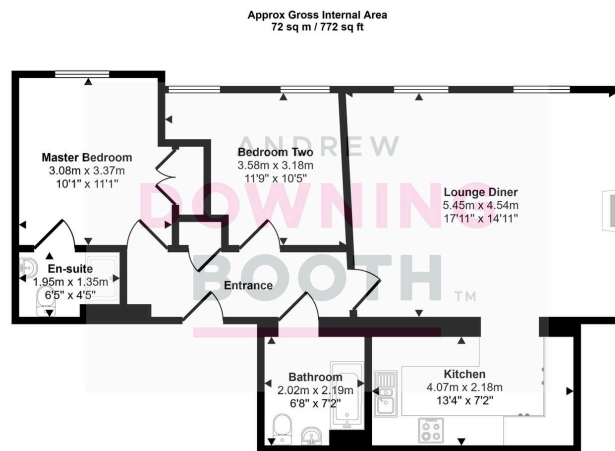

Floorplan

This floorplan is only for illustrative purposes and is not to scale. Measurements of rooms, doors, windows, and any items are approximate and no responsibility is taken for any error, omission or mis-statement. Icons of items such as bathroom suites are representations only and may not look like the real items. Made with Made Snappy 360.

- Two Bedroom Apartment
- Superb City Centre Location
- Parking Space Available
- Fabulous Open Plan Living / Kitchen / Diner
- Master Bedroom With Ensuite Shower Room
- Superb Exclusive Roof Terrace Only For Residents
- New Boiler April 2024
- Council Tax Band: C
- EPC Rating: C

