



Highcroft Crescent, Lichfield - No Upward Chain

£325,000

2 1 3



Beautifully positioned on the desirable Highcroft Crescent, this two-bedroom detached bungalow offers spacious single-storey living in a peaceful and well-established part of Lichfield.

Highcroft Crescent is a quiet residential street set within the popular Boley Park area of Lichfield. The location is ideal for families, offering access to well-regarded local schools including Scotch Orchard Primary and King Edward VI School. A range of nearby amenities includes shops, cafes, a supermarket, and medical facilities, all within easy reach. Excellent transport links are available via Lichfield Trent Valley and City stations, providing direct routes to Birmingham and London. The historic city centre is just a short distance away, making this a highly convenient and appealing place to live.

The accommodation is set across one floor with an entrance hall/reception room, inner hall which provides access to the family bathroom, Master Bedroom and second spacious bedroom. There is a further rear living room with French doors opening out to the garden, open plan kitchen/diner and useful utility room.

To fully appreciate the space, setting, and potential this charming bungalow has to offer, viewing is highly recommended—early booking is advised to avoid disappointment.





- Two Bedroom Detached Bungalow
- Generous Sized Plot & Private Garden
- Useful Utility Room
- EPC Rating: TBC
- No Upward Chain
- Open Plan Kitchen/Diner
- Idyllic Location - Close to Local Shops & Schools
- Council Tax Band: C

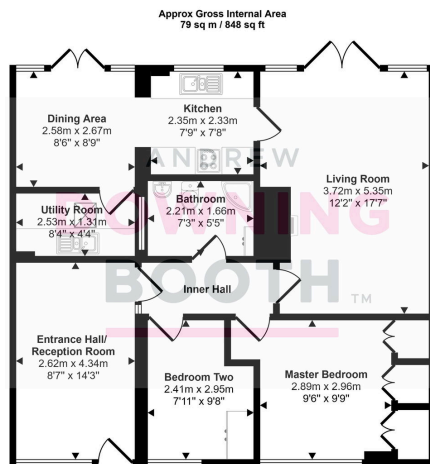

Floorplan

This floorplan is only for illustrative purposes and is not to scale. Measurements of rooms, doors, windows, and any items are approximate and no responsibility is taken for any error, omission or mis-statement. Icons of items such as bathroom suites are representations only and may not look like the real items. Made with Made Snippy 360.

