



No Upward Chain - Pear Tree Close, Lichfield

£200,000

🛏 2 🚿 2 🛋 1



No upward chain & recently professionally decorated - A consistently spacious and ready-to-go two bedroom ground floor apartment, less than half a mile from Lichfield's thriving city centre.

Location-wise, the property benefits from a particularly convenient position, sitting within walking distance to both Lichfield City train station and the city centre itself, as well as there being major supermarkets and highly rated schools also nearby. Lichfield is home to a wealth of amenities, including the award-winning Beacon Park, a Michelin-starred restaurant and Lichfield Cathedral.

The accommodation itself consists of a welcoming entrance hall, fabulous living room (with French doors opening out to a charming leafy patio), attractive fitted kitchen, two generous bedrooms and the stunning main bathroom, with the Master enjoying its own en-suite shower room and built in wardrobes. Externally, wonderfully maintained communal grounds include a privately allocated car parking space and further visitor parking.

Whether it be for an investment, first-time buy, downsize or as a base for any commuters, this property has something for everyone. We must advise booking in a viewing at your earliest convenience to avoid disappointment.



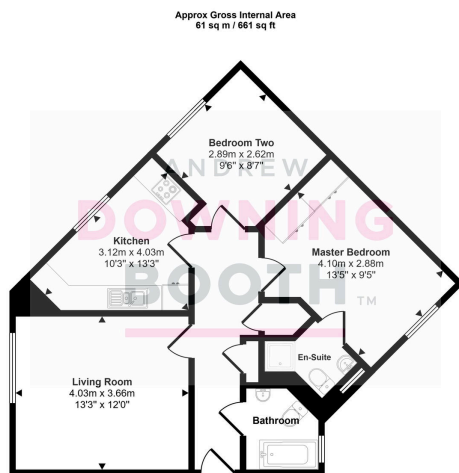

Floorplan

This floorplan is only for illustrative purposes and is not to scale. Measurements of rooms, doors, windows, and any items are approximate and no responsibility is taken for any error, omission or mis-statement. Icons of items such as bathroom suites are representations only and may not look like the real items. Made with Made Snappy 360.

- Professionally Decorated Two Bedroom Ground Floor Apartment
- Master Bedroom With Built In Wardrobes & En-Suite
- Allocated & Numbered Parking Space Plus General Visitor Parking
- Light & Airy Living Room With French Doors Out To Private Patio
- EPC Rating: C
- No Upward Chain
- Convenient Location Within Walking Distance To Lichfield City Train Station
- Impressive Room Sizes Throughout
- Very Attractive & Contemporary Bathroom
- Council Tax Band: B

