



Osprey Close, Whittington, Lichfield

£525,000

4 2 3



A rare opportunity to acquire a superb four bedroom detached family home, nestled on a quiet and leafy cul-de-sac within this popular residential address in the highly desirable village of Whittington.

The picturesque village of Whittington is an incredibly sought after area and it's no wonder as to why, with abundant scenic surrounding countryside, easy access to the highly regarded Whittington Primary School and King Edwards VI Secondary School, Lichfield and other surrounding areas, with both Bit End Field and the Birmingham and Fazeley canal just a short walk away.

The accommodation is set across two floors, with the ground floor home to three generous and separate reception rooms, fabulous breakfast kitchen and guest WC, whilst to the first floor are all four bedrooms (Master with en-suite) and the very tasteful and contemporary main bathroom. A tarmacadam driveway provides off road parking whilst mature lawned gardens sit to both the front and rear to make up the property's exterior.

Living space, bedroom space and an incredibly desirable location; this property wants for nothing and simply must be viewed in order to be appreciated.



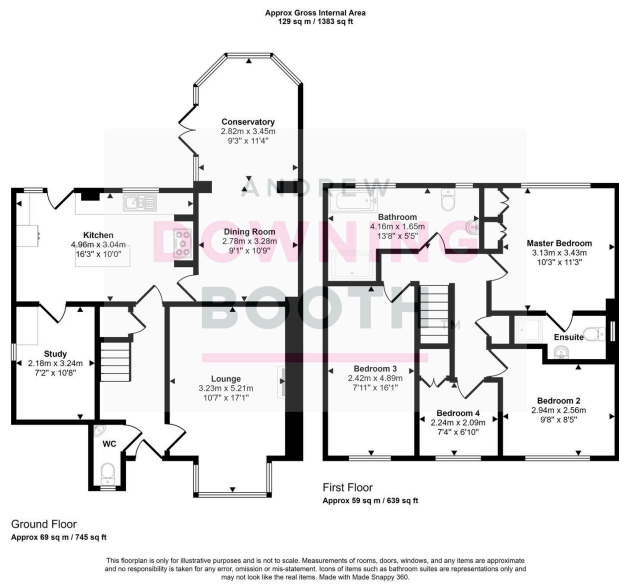

- Four Bedroom Detached
- Exceptional Living Space Property
- Consistently Generous Room Sizes
- Highly Desirable Village Location
- Master Bedroom With Built In Wardrobes & En-Suite
- Fabulous Breakfast Kitchen
- EPC Rating: D
- Council Tax Band: F

