



Foxglove Close, Lichfield

Offers Over £290,000

3 1 1



Coming to the market presented to a wonderful standard throughout, it's safe to say that this is sure to be popular! With a GARAGE sitting in a separate block and a landscaped garden to the rear, it isn't just the accommodation that's impressively appointed either! Sitting in a cul-de-sac position and comprising an entrance hall, living room and stunning kitchen diner with doors opening to the garden. To the first floor is a contemporary shower room and three bedrooms whilst outside is a very attractive rear garden with gate providing access, along with a parking space sitting in front of the garage. The property is a must view to appreciate it's stunning accommodation so don't miss out and book in your visit today!



ANDREW
**DOWNING
BOOTH**
ESTATE AGENTS



ANDREW
**DOWNING
BOOTH**
ESTATE AGENTS

Approx Gross Internal Area
70 sq m / 756 sq ft

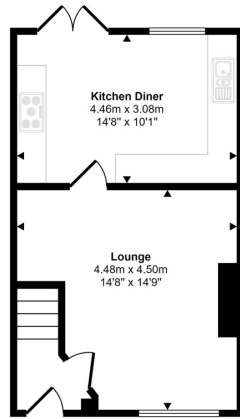

Ground Floor
Approx 35 sq m / 376 sq ft

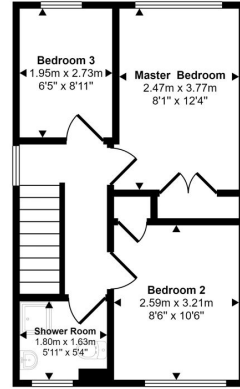

First Floor
Approx 35 sq m / 380 sq ft

This floorplan is only for illustrative purposes and is not to scale. Measurements of rooms, doors, windows, and any items are approximate and no responsibility is taken for any error, omission or mis-statement. Icons of items such as bathroom suites are representations only and may not look like the real items. Made with Made Snappy 360.

- Three Bedroom End Of Terraced Home
- Large Living Room & Spacious Contemporary Kitchen Diner
- Attractive Landscaped Garden
- Stunning Presentation Throughout
- Modern Shower Room
- GARAGE & Parking Space

