



# Leofric Close, Kings Bromley, Burton-on-Trent

£545,000

🛏️ 4 🚗 3 🛋️ 3



An impeccably presented and consistently spacious four bedroom home, nestled in a quiet spot within the highly desirable village of Kings Bromley. This fantastic detached property boasts an extensive range of fabulous features, from the stunning high specification breakfast kitchen/diner with bi-fold doors out to the garden, to the large living and dining rooms and the attractive outlook over a neighbouring green.

Location-wise, Kings Bromley is one of Staffordshire's most sought after villages, with its endless charm and scenic surrounding countryside, whilst still maintaining easy access to Lichfield, Rugeley and other surrounding areas.

The accommodation is set across two floors, with an entrance hall, a generous living room with cast iron fire leading through to the dining room, separate sitting room/home office, hugely impressive breakfast kitchen/diner and guest WC all to the ground floor, whilst the four main bedrooms (Master with en-suite) and attractive bathroom sit to the first floor. A double width driveway and large garage is coupled with a well maintained, private rear garden to make up the property's exterior.

A significantly enviable location, exceptional presentation and ample space across both floors; this property must be viewed in order to be appreciated.



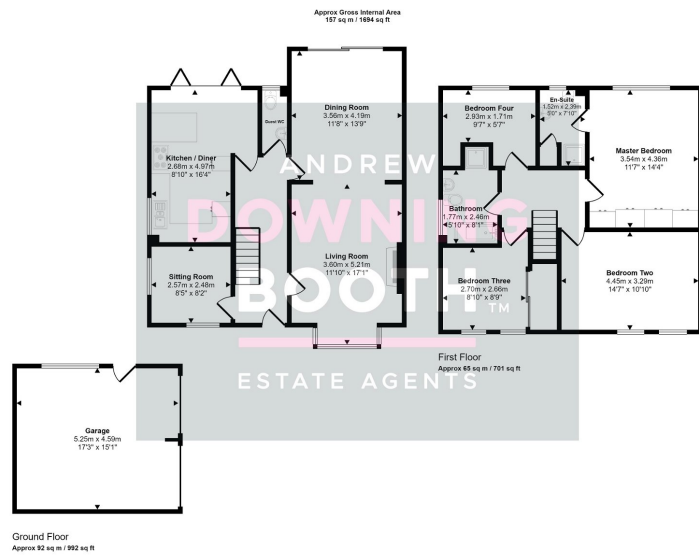

Ground Floor  
Approx 92 sq m / 992 sq ft

This floorplan is only for illustrative purposes and is not to scale. Measurements of rooms, doors, windows, and any items are approximate and no responsibility is taken for any errors, omissions or misstatements. Some of items such as bathroom suites are representations only and may not look like the real items. Made with Maple Snappy 300.

- Four Bedroom Detached Property
- Beautifully Presented Throughout
- Fabulous Outlook To A Neighbouring Green
- Stunning High Specification Kitchen / Diner With Bi-Fold Doors Out To The Garden
- Fabulous Master Bedroom With En-Suite
- Consistently Generous Room Sizes
- Quiet Position Within Highly Desirable Village Of Kings Bromley
- Separate Living Room, Dining Room & Sitting Room
- EPC Rating: C
- Council Tax Band: F

