



ABNALLS
COURT

Abnalls Court, Abnalls Lane, Lichfield

Offers In Region Of £150,000

2 1 1



A very charming and consistently spacious two double bedroom apartment in a very popular and highly convenient part of Lichfield, sitting to the first floor and coming with the rare added benefit of having no upward chain. This charming property at Abnalls Court comes to the market with plenty of attractive features, from the consistently generous room sizes, to coming with its own private garage and enjoying the immaculately maintained communal gardens. Location-wise, the property sits just over half a mile from the very centre of Lichfield, with excellent access to various amenities, including various bars/restaurants, highly rated schools and transport links, whilst the picturesque and historic Beacon Park is just a few minutes' walk away. The accommodation consists of a private entrance hall, large living room with its own private balcony, dining room, kitchen, two double bedrooms and the attractive main bathroom. Properties offering this much value for money, in such a desirable part of Lichfield, can only be truly appreciated when viewed in person.

The property is leasehold with a term of 49 years remaining. There is a bi-annual service charge, with the most recent figures totalling £1293.70 for 2024. There is an annual ground rent of £50 per year.

Please note that due to the length of the lease remaining, this property is only likely to be suitable for cash buyers. Probate has also been granted to allow for a quick sale.



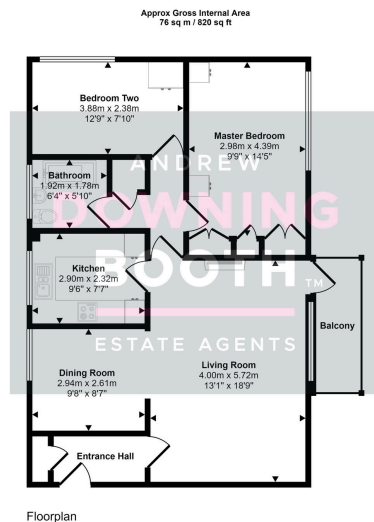

This floorplan is only for illustrative purposes and is not to scale. Measurements of rooms, doors, windows, and any items are approximate and no responsibility is taken for any error, omission or mis-statement. Icons of items such as bathroom suites are representations only and may not look like the real items. Made with Made Snappy 360.

- Cash Buyers Only
- No Upward Chain
- Two Double Bedroom First Floor Apartment
- Spacious Accommodation Throughout
- Impressive Living Room With Private Balcony
- Beautifully Maintained Communal Gardens
- EPC Rating: D
- Council Tax Band: C

