



**ABNALLS
COURT**

Abnalls Court, Abnalls Lane, Lichfield

£170,000

🛏️ 2 🪑 1 🚗 1



CASH BUYERS ONLY - A very charming and consistently spacious two double bedroom apartment in a very popular and highly convenient part of Lichfield, sitting to the first floor and coming with the rare added benefit of having no upward chain. This charming property at Abnalls Court comes to the market with plenty of attractive features, from the consistently generous room sizes, to coming with its own private garage and enjoying the immaculately maintained communal gardens. Location-wise, the property sits just over half a mile from the very centre of Lichfield, with excellent access to various amenities, including various bars/restaurants, highly rated schools and transport links, whilst the picturesque and historic Beacon Park is just a few minutes' walk away. The accommodation consists of a private entrance hall, large living room with its own private balcony, dining room, kitchen, two double bedrooms and the attractive main bathroom.



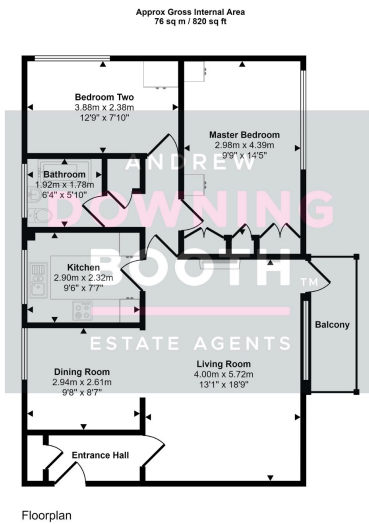

This floorplan is only for illustrative purposes and is not to scale. Measurements of rooms, doors, windows, and any items are approximate and no responsibility is taken for any error, omission or mis-statement. Icons of items such as bathroom suites are representations only and may not look like the real items. Made with Made Snappy 360.

- Two Double Bedroom First Floor Apartment
- No Upward Chain
- Cash Buyers Only
- Spacious Accommodation Throughout
- Impressive Living Room With Private Balcony
- Beautifully Maintained Communal Gardens
- EPC Rating: D
- Council Tax Band: C

