



ANDREW  
**DOWNING**  
**BOOTH**™  
ESTATE AGENTS



# Cheshire Close, Burntwood

£595,000

🛏️ 4 🚿 2 🚗 3





A substantial four bedroom home, occupying a set back position within the always popular and highly desirable St Matthews estate in Burntwood. This beautifully presented detached property in Cheshire Close comes to the market with an extensive range of attractive features, from the incredibly generous choice of living space, to the immaculate condition with upgrades and improvements throughout. The accommodation is set across two floors, with a fabulous entrance hall setting the tone, spacious living room, dining room with bay window, conservatory, office/study, truly stunning breakfast kitchen/diner, utility room and guest WC all to the ground floor whilst the four good size bedrooms (Master with en-suite) and main family bathroom occupy the first, accessed via a bright galleried landing. Externally, the property sits upon an attractive yet low maintenance plot, set back from the road, with a detached double garage and driveway to the frontage whilst a private and South-facing lawned garden and Indian sandstone paving occupy the rear. It's very difficult to find a box not ticked with this exceptional property; a closer inspection is absolutely essential to appreciate all that's on offer.



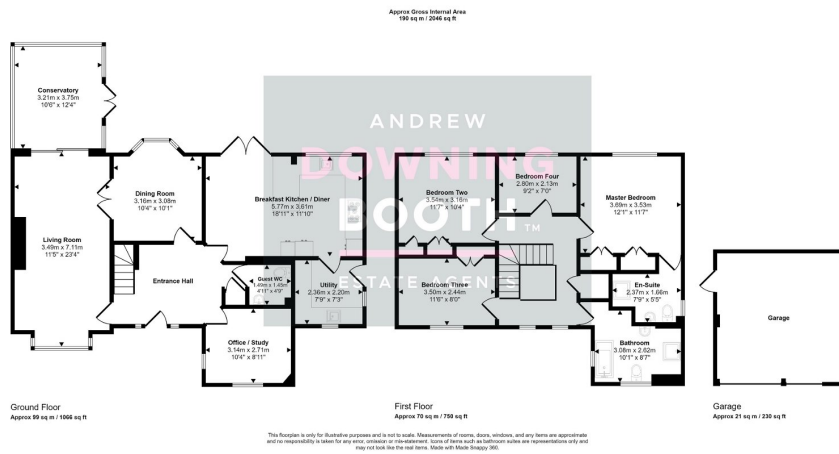

- Generous Four Bedroom Detached Property
- Exceptional Living Space
- Detached Double Garage
- Very Popular Location
- Beautifully Presented Throughout
- Master Bedroom With Built In Wardrobes & En-Suite
- Stunning Kitchen / Diner & Bathroom
- Attractive Plot Set Back From Road
- EPC Rating: D
- Council Tax Band: F



Score	Energy rating	Current	Potential
92+	A		
81-91	B		85 B
69-80	C		
55-68	D	65 D	
39-54	E		
21-38	F		
1-20	G		