



ANDREW  
**DOWNING**  
**BOOTH**™  
ESTATE AGENTS

# Park End, Boley Park, Lichfield

£495,000

3 1 1



**A very rare opportunity to acquire a substantial and wonderfully located detached bungalow with no upward chain. This fabulous three bedroom home in Park End of Boley Park, Lichfield, comes to the market boasting an impressive range of features, from the stunning plot to the dual aspect lounge/diner and double garage. Nestled within Boley Park, one of Lichfield's most heavily desired areas, this property is just a short way away from Lichfield City Centre, with easy access to local shops, a charming café, the popular Turnpike pub and even a gym, as well as major supermarkets, train stations and Darnford Park just a short walk away too. The accommodation itself benefits from generous room sizes and a real feeling of space throughout, comprising an entrance hall, large dual aspect lounge/diner, kitchen with utility area, conservatory, three bedrooms and two separate shower rooms. Externally, the property sits on a private and fabulous plot, with charming gardens laid mainly to lawn sitting to both the front and rear, with a double garage and double width driveway also both available. The opportunity to acquire a bungalow in Boley Park is not often found, let alone one that offers this level of space and flexibility whilst also having no upward chain; we must advise booking in a viewing at your earliest convenience.**



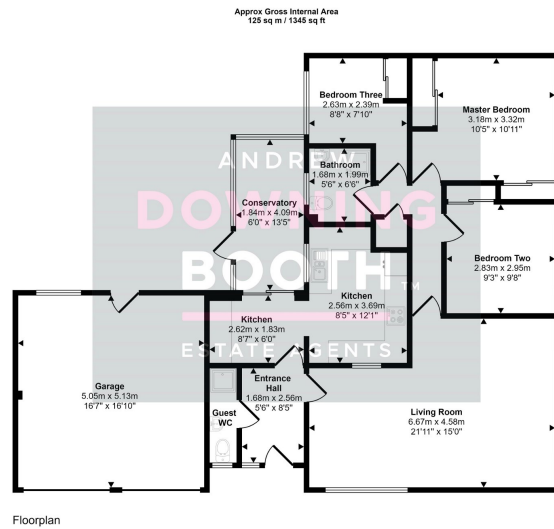

This floorplan is only for illustrative purposes and is not to scale. Measurements of rooms, doors, windows, and any items are approximate and no responsibility is taken for any error, omission or mis-statement. Icons of items such as bathroom suites are representations only and may not look like the real items. Made with Madz Snappy 360.

- Three Bedroom Detached Bungalow
- Double Garage & Double Width Driveway
- Separate Bathroom & Shower Room
- EPC Rating: TBC
- No Upward Chain
- Spacious, Dual Aspect Lounge/Diner
- Private Garden
- Council Tax Band: E

