



# Foxglove Close, Lichfield

Offers Over £250,000

2 1 1



Calling all first time buyers, investors and downsizers! This is the property you've all been waiting for. Coming with generous room dimensions, a spacious and mature garden and even a GARAGE. Sitting in the south side of the city with great access to amenities, this property comes to the market well presented and comprises an entrance hall with guest WC off, a very spacious lounge diner and kitchen. Upstairs are two generous double bedrooms both with built in wardrobes as well as a family bathroom. Outside is a fabulous South-facing mature garden with gated access, a block paved area, colourful well stocked shrub beds and a useful garden shed. A parking space sits in front of the garage. This is a property which ticks a lot of boxes, and really does offer plenty of space for a two bedroom home, so don't miss out and book in an early viewing!

**Entrance Hall**

**Guest WC**

**Lounge / Diner - 4.95m x 3.75m (16'2" x 12'3")**

**Kitchen - 2.76m x 2.49m (9'0" x 8'2")**

**Landing**

**Master Bedroom - 3.24m x 2.96m (10'7" x 9'8")**

**Bedroom Two - 3.74m x 2.48m (12'3" x 8'1")**

**Bathroom**

**Garage**



ANDREW  
**DOWNING  
BOOTH**  
ESTATE AGENTS



ANDREW  
**DOWNING  
BOOTH**  
ESTATE AGENTS

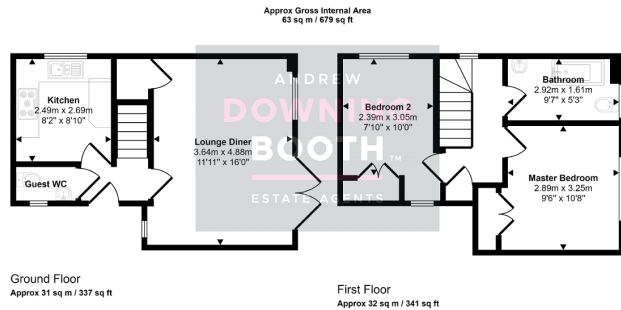

This floorplan is only for illustrative purposes and is not to scale. Measurements of rooms, doors, windows, and any items are approximate and no responsibility is taken for any error, omission or mis-statement. Icons of items such as bathroom suites are representations only and may not look like the real items. Made with Made-Snapppy 360.

- Two Double Bedroom Terraced Home
- Bathroom & Guest WC
- Parking Space & Garage
- Lounge Diner & Kitchen
- Cul-De-Sac Location
- Mature, Private Rear Garden

