



Lincoln Close, Lichfield

£325,000

3 1 3



DESCRIPTION

A very spacious three bedroom home in a popular location. This charming end of terrace property in Lincoln Close, Lichfield, comes to the market with an impressive range of features, from the three good size bedrooms, to the three separate reception rooms and large corner plot. Immaculately maintained gardens sit to both the front of the property, with the rear housing a summerhouse and garden shed. Internally, the ground floor of the property comprises an entrance hall, living room, garden room, sitting room, generous kitchen and guest WC whilst to the first floor are the three main bedrooms, a shower room and separate WC. The property is located in a popular part of Lichfield, being just a five minute drive from the centre and also close to various schools, supermarkets and transport links. A large car port sits to one side of the property, whilst there are three additional spaces for cars; two the front, two to the rear. Properties with this much on offer must be viewed.



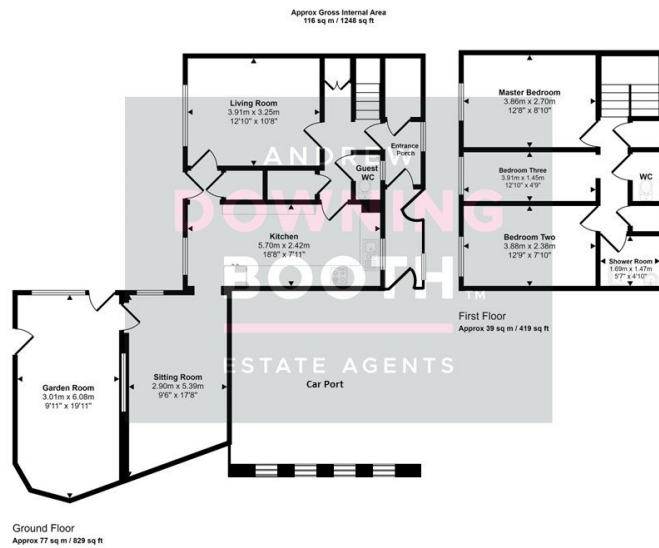

This floorplan is only for illustrative purposes and is not to scale. Measurements of rooms, doors, windows, and any items are approximate and no responsibility is taken for any error, omission or mis-statement. Icons of items such as bathroom suites are representations only and may not look like the real items. Made with Made Sprazzy 360.

- Three Bedroom End Of Terrace Property
- Spacious Corner Plot With Car Port
- Extended & Generous Kitchen
- EPC Rating: TBC
- Three Separate Reception Rooms
- Off Road Parking For Four Cars
- Popular Location
- Council Tax Band: B

