



Oaklands, Sutton Coldfield

£385,000

3 1 2



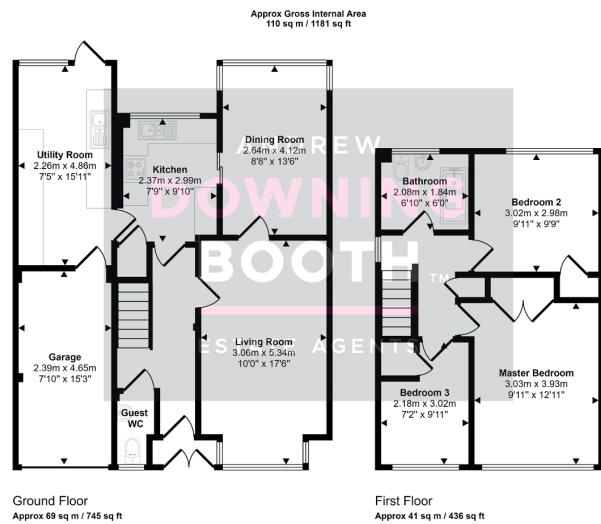

This floorplan is only for illustrative purposes and is not to scale. Measurements of rooms, doors, windows, and any items are approximate and no responsibility is taken for any error, omission or mis-statement. Icons of items such as bathroom suites are representations only and may not look like the real items. Made with Made Snappy 360.



Sitting on the popular 'Oaklands', this property has potential to extend (subject to gaining the necessary planning permissions), and whilst it does require some modernising, it boasts huge potential. The property comes with no upward chain and benefits from having a practical layout with generous dimensions. Comprising an entrance hall, entrance porch, large living room, separate extended dining room and kitchen (which could be knocked into each other subject to gaining the necessary building regulations). There is also a guest WC and large utility room to the ground floor. Upstairs are three bedrooms as well as a family bathroom. Outside is a reasonably low maintenance yet pretty garden, with a block paved drive to the front providing ample off street parking with an artificial lawned front garden.

