



REGENT  
ESTATES

# PRIORY COURT, BERKHAMSTED

£350,000 Leasehold

---

## ACCOMMODATION

Located in the heart of Berkhamsted town, this spacious apartment is perfectly positioned to enjoy everything the town has to offer. Stunning views, allocated parking and offering a kitchen/breakfast room, two double bedrooms, bathroom and excellently proportioned living/dining room. Offered for sale with a long lease and no onwads chain.

A front door opens to a spacious entrance hall. From here a door to your right hand side opens to the fitted kitchen/breakfast room which has a window overlooking the front.

A door opens to bedroom two which has triple fitted wardrobes with ample hanging and storage space. Both the living room and the principal bedroom are positioned at the rear and boast two windows allowing natural light to flood these rooms.

The principal bedroom also has a comprehensive range of fitted wardrobes. A main bathroom fitted with a white suite including panelled bath with shower screen and shower unit over, complete the accommodation.

The property offers the convenience of resident covered parking space, ensuring that you always have a dedicated space for your vehicle. Residents can also take advantage of the communal gardens,

The flat's prime location in Berkhamsted means you'll have easy access to local amenities, shops, restaurants, and public transport and its chain-free status and low service charge add to its appeal, making it an attractive investment for homeowners or investors alike.

## LOCATION

## OUTSIDE

## IMPORTANT NOTICE

1. These sales particulars have been prepared from information supplied by the vendors and information collated by Regent Estates.
2. Confirmation has been sought from the vendors to confirm these particulars accuracy.
3. All measurements given have a tolerance of 3" in accordance with RICS Code of Measuring Practice.
4. None of these appliances, plumbing or electrics mentioned within these particulars have been tested by ourselves, prospective purchasers are urged to check their condition before entering in to purchase.

## VIEWING

Strictly by appointment through Regent Estates.

01442 877878  
141-143 High Street, Berkhamsted, Herts,  
HP4 3HH

Email: [info@regent-estates.com](mailto:info@regent-estates.com)  
[www.regent-estates.com](http://www.regent-estates.com)





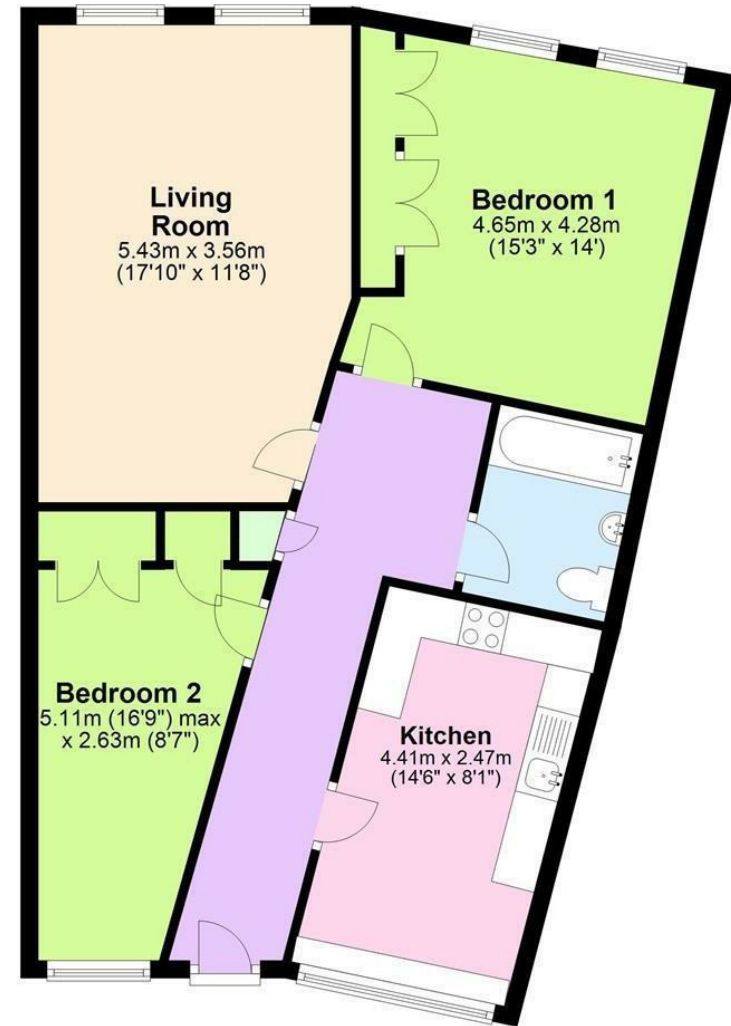

**Ground Floor**

Approx. 70.5 sq. metres (759.1 sq. feet)

Total area: approx. 70.5 sq. metres (759.1 sq. feet)

All measurements are approximate.  
Plan produced using PlanUp.

**REGENT  
ESTATES**

TELEPHONE: 01442 877878  
141-143 High Street, Berkhamsted,  
Herts, HP4 3HH  
Email: info@regent-estates.com  
www.regent-estates.com