



Woodcote Drive, BR6 8DT £1,450 pcm

A rarely available furnished, three bedroom split level maisonette, which is ready for immediate occupation is situated within the catchment areas for Crofton Schools and Darrick Wood, as well as being within easy walking distance of Orpington mainline station. Phone today to view.



Property Features

- Split level maisonette
- Three bedrooms
- Furnished
- Popular location
- Available now

Full Description

FRONT

HALLWAY

Storage cupboard and stairs leading to first floor.

LOUNGE

17' 2" x 16' 2" at max points (5.23m x 4.93m)

KITCHEN

16' x 8' (4.88m x 2.44m)

Extended kitchen.

STAIRS TO 2ND FLOOR LANDING

2ND FLOOR LANDING

BEDROOM ONE

13' 4" x 9' 5" excluding fitted wardrobes (4.06m x 2.87m)

BEDROOM TWO

10' 1" x 9' 8" excluding fitted wardrobes (3.07m x 2.95m)

BEDROOM THREE

10' 1" x 6' 5" (3.07m x 1.96m)

BATHROOM

DIRECTIONS

From Petts Wood, Station Square, proceed down Fairway and right into Tudor Way. Left at mini-roundabout into Towncourt Lane. Over mini-roundabout into Crofton Lane and second left into Place Farm Avenue. Right round bend and then left, take first left into Woodcote Drive.





Score	Energy rating	Current	Potential
92+	A		
81-91	B		
69-80	C	69 c	77 c
55-68	D		
39-54	E		
21-38	F		
1-20	G		



GROUND FLOOR

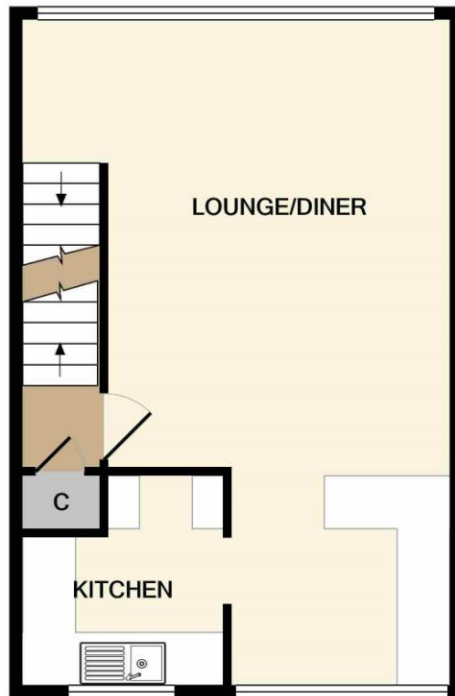

1ST FLOOR

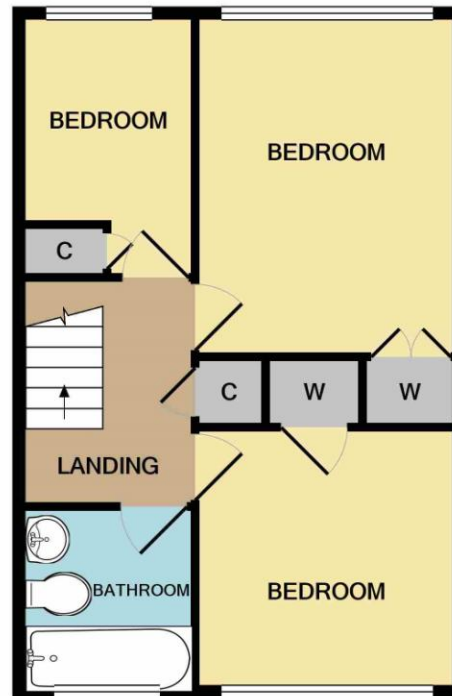

2ND FLOOR

Made with Metropix ©2020

26 Station Square
Petts Wood
Kent
BR5 1NA

www.edmund.co.uk
pettswood@edmund.co.uk
01689 819 991

Agents Note: Whilst every care has been taken to prepare these particulars, they are for guidance purposes only. All measurements are approximate and for general guidance purposes only and whilst every care has been taken to ensure their accuracy, they should not be relied upon and potential tenants are advised to recheck the measurements