



68 Glentrammon Road, Orpington, BR6 6DG

Nestled on the charming Glentrammon Road, this delightful three-bedroom house offers a perfect blend of comfort and convenience. Upon entering, you are welcomed into a spacious reception room, ideal for both relaxation and entertaining guests. The property boasts three well-proportioned bedrooms, providing ample space for family living or accommodating guests.

The house features a modern bathroom with a separate shower cubicle, ensuring that your daily routines are both comfortable and efficient. Additionally, a convenient downstairs toilet adds to the practicality of the home, making it suitable for families and visitors alike.

For those who appreciate outdoor space, the property includes a lovely garden, perfect for enjoying sunny days or hosting barbecues with friends and family. The garden offers a serene retreat from the hustle and bustle of daily life.

Parking is made easy with off-street parking available, along with a garage that provides extra storage or secure parking options. This feature is particularly valuable in a busy residential area.

In summary, this charming house on Glentrammon Road is an excellent opportunity for anyone seeking a comfortable family home with ample space, modern amenities, and convenient parking. Don't miss the chance to make this delightful property your own.

- Three bedroom house
- Garage
- Off street parking
- Downstairs toilet
- Separate shower cubicle
- Close to station/ shops
- Council Tax E
- EPC D

£1,900 Per Month

GROUND FLOOR
554 sq.ft. (51.5 sq.m.) approx.

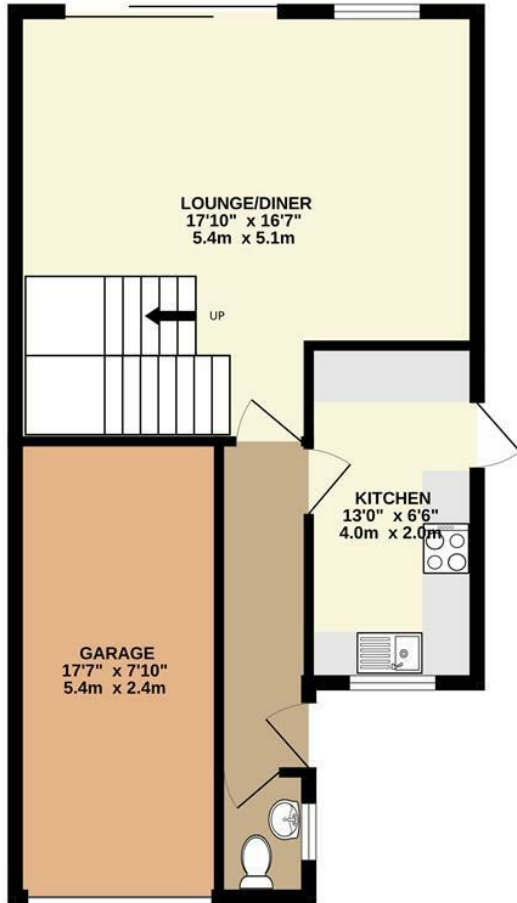

1ST FLOOR
461 sq.ft. (42.8 sq.m.) approx.

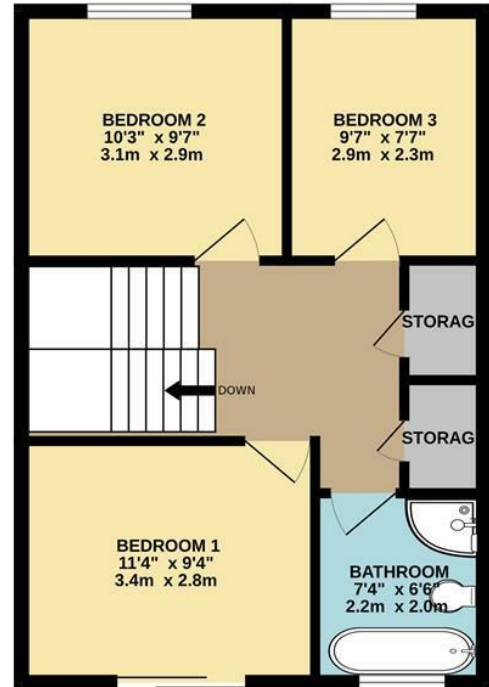

TOTAL FLOOR AREA : 1015 sq.ft. (94.3 sq.m.) approx.

Whilst every attempt has been made to ensure the accuracy of the floorplan contained here, measurements of doors, windows, rooms and any other items are approximate and no responsibility is taken for any error, omission or mis-statement. This plan is for illustrative purposes only and should be used as such by any prospective purchaser. The services, systems and appliances shown have not been tested and no guarantee as to their operability or efficiency can be given.
Made with Metropix ©2025

