



£335,000
Villa May Lakeswood Road
Petts Wood, Orpington, BR5 1BJ

£335,000



Villa May Lakeswood Road

Petts Wood, Orpington, BR5 1BJ

Welcome to Lakeswood Road, Petts Wood - a charming location perfect for those seeking a modern and convenient lifestyle. This first-floor apartment, set in a block of just 5 properties, boasts an open plan reception room with an integrated high gloss kitchen with room for a breakfast bar, island or dining table. There is a double bedroom, and a well-appointed bathroom, making it an ideal space for first-time buyers or savvy investors.

Situated moments from Petts Wood station, commuting couldn't be easier, offering a seamless blend of city access and suburban tranquility. With parking available for one vehicle, convenience is truly at your doorstep.

This chain-free sale presents a fantastic opportunity to own a well-finished property in the sought-after area of Petts Wood. Don't miss out on the chance to make this apartment your own and enjoy all that it has to offer.

Bedroom

11'9 x 10'2 (3.35m'2.74m x 3.05m'0.61m)

Living Room / Kitchen

22'7 x 12'8 (6.71m'2.13m x 3.66m'2.44m)

Bathroom

7'2 x 6'10 (2.13m'0.61m x 1.83m'3.05m)



Floor Plan

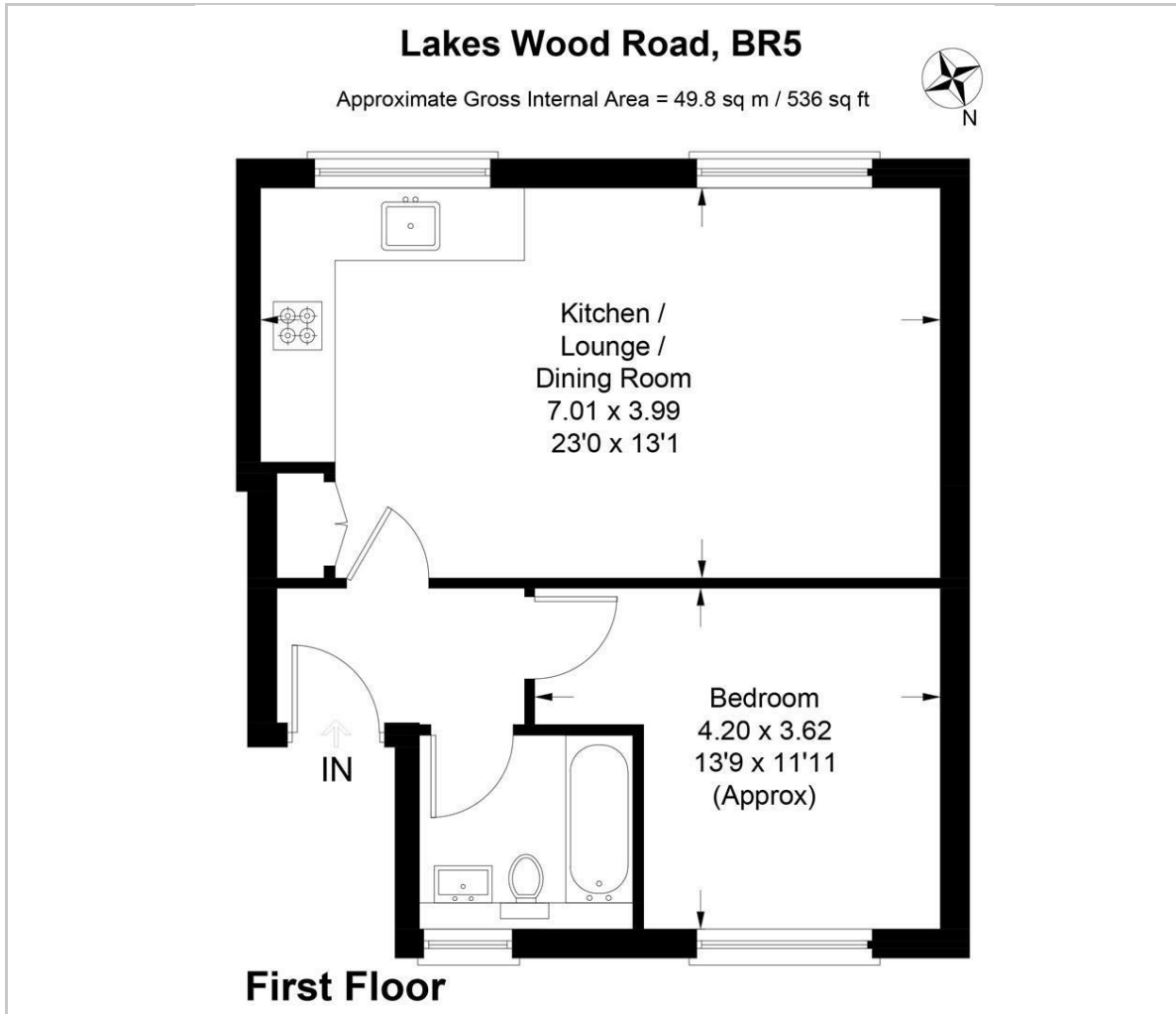

Viewing

Please contact our Petts Wood Office on 01689 819991 if you wish to arrange a viewing appointment for this property or require further information.

These particulars, whilst believed to be accurate are set out as a general outline only for guidance and do not constitute any part of an offer or contract. Intending purchasers should not rely on them as statements of representation of fact, but must satisfy themselves by inspection or otherwise as to their accuracy. No person in this firm's employment has the authority to make or give any representation or warranty in respect of the property.

26 Station Square, Petts Wood, Kent, BR5 1NA
 Tel: 01689 819991 Email: pettswood@edmund.co.uk <https://www.edmund.co.uk/>

Area Map

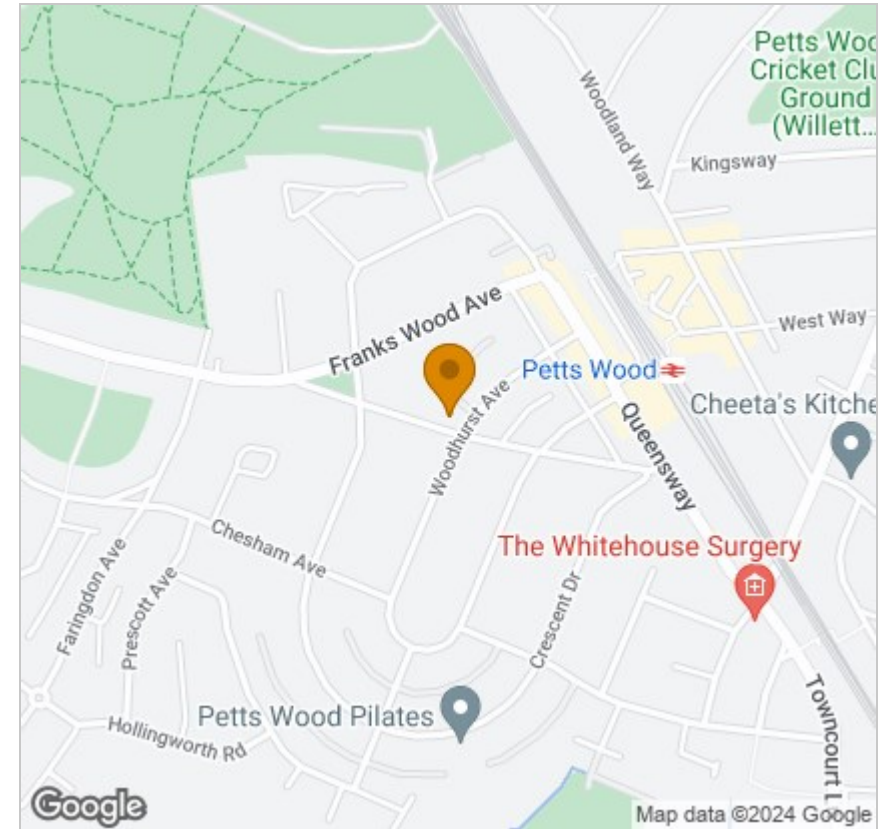

Energy Efficiency Graph

