



Elmhurst Drive, South Woodford

Guide price £675,000 to £700,000 Freehold

Advising on **local property** since 1984

**Neil King**

Guide Price £675,000 - £700,000 -1930s end of terrace three bedroom bright family home offering a south facing garden and attached garage.  
 Elmhurst Drive is situated in popular location and is within easy walking distance of George Lane shops, restaurants and South Woodford Central Line station offering a direct commute

- End of terrace**
- Three bedrooms**
- South facing garden**
- Bright through lounge**
- Ground floor WC**
- Attached garage**



**Elmhurst Drive, South Woodford, London E18**

Approximate Area = 908 sq ft / 84.3 sq m  
 Garage = 159 sq ft / 14.7 sq m (includes store)  
 Total = 1067 sq ft / 99.1 sq m  
 For identification only - Not to scale

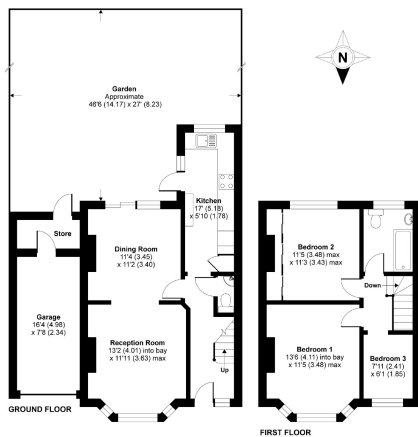

RICS Certified Property Measurement Floor plan produced in accordance with RICS Property Measurement Standards incorporating International Property Measurement Standards (IPMS) (Residential - Woodhouse 2021) Protocol for Real Estate Agents - RPS 700020

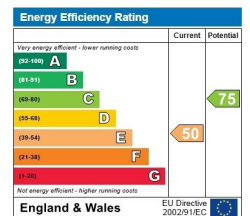

tel: **020 8220 9000**  
 email: **sales@nkres.co.uk**

Are you **thinking of selling** your home?  
 If you're **considering selling** your home, please contact us today for a **free market appraisal**.

10 Electric Parade, George Lane, South Woodford, London E18 2LY

**www.nkres.co.uk**

PROPERTY MISDESCRIPTIONS ACT 1991: The Agents has not tested any apparatus, equipment, fixtures and fittings, or services, so cannot verify that they are in working order or fit for the purpose. The buyer is advised to obtain their own verification. References to the Tenure of the property are based on information supplied by the Vendor. The agents have not had sight of the title documents. The buyer is advised to obtain verification from their Solicitor. You are advised to check the availability of any property before travelling any distance to view.