



MEACOCK & JONES

4 Bedrooms

Farmhouse

Located in Fryerning

£1,495,000



enquiries@meacockjones.co.uk

www.meacockjones.co.uk

01277 218485

Glebe Cottage Blackmore Road Fryerning

Ingatestone | | CM4 0NW



MEACOCK & JOY

A most charming, four bedroom period farmhouse, located in the very heart of Fryerning.

Dating back to circa 1750, with later additions, this appealing property is situated on a spacious plot, approaching two acres, and is surrounded by panoramic country views. Accommodation comprises 2,897 square feet of well organised accommodation, hosting a wealth of period features.

The spacious living areas are very versatile, incorporating five well proportioned reception rooms and an open plan kitchen/breakfast room; ideal for modern family life. The gardens measure approximately 650' in width and are flanked by open farmland. The grounds incorporate two lakes, a heated swimming pool and a triple garage.

Glebe Cottage is positioned just 1.4 mile from Ingatestone mainline railway station and is within easy reach of Brentwood, New Hall and the Anglo European Schools.



Glebe Cottage Blackmore Road

£1,495,000 Freehold

- Four Bedrooms
- Five Reception Rooms
- Utility Area
- 2,897 Square Feet
- Swimming Pool
- Two Bath/Shower Rooms
- Kitchen/Breakfast Room
- Triple Garage
- 1.93 Acre Grounds
- No Onward Chain





APPROX INTERNAL FLOOR AREA
270 SQ M 2897 SQ FT
INCLUDING TRIPPLE GARAGE

This plan is for layout guidance only and is
NOT TO SCALE

Whilst every care is taken in the preparation
of this plan, please check all dimensions,
shapes & compass bearings before making
any decisions reliant upon them.

Copyright Meacock & Jones



Ground Floor

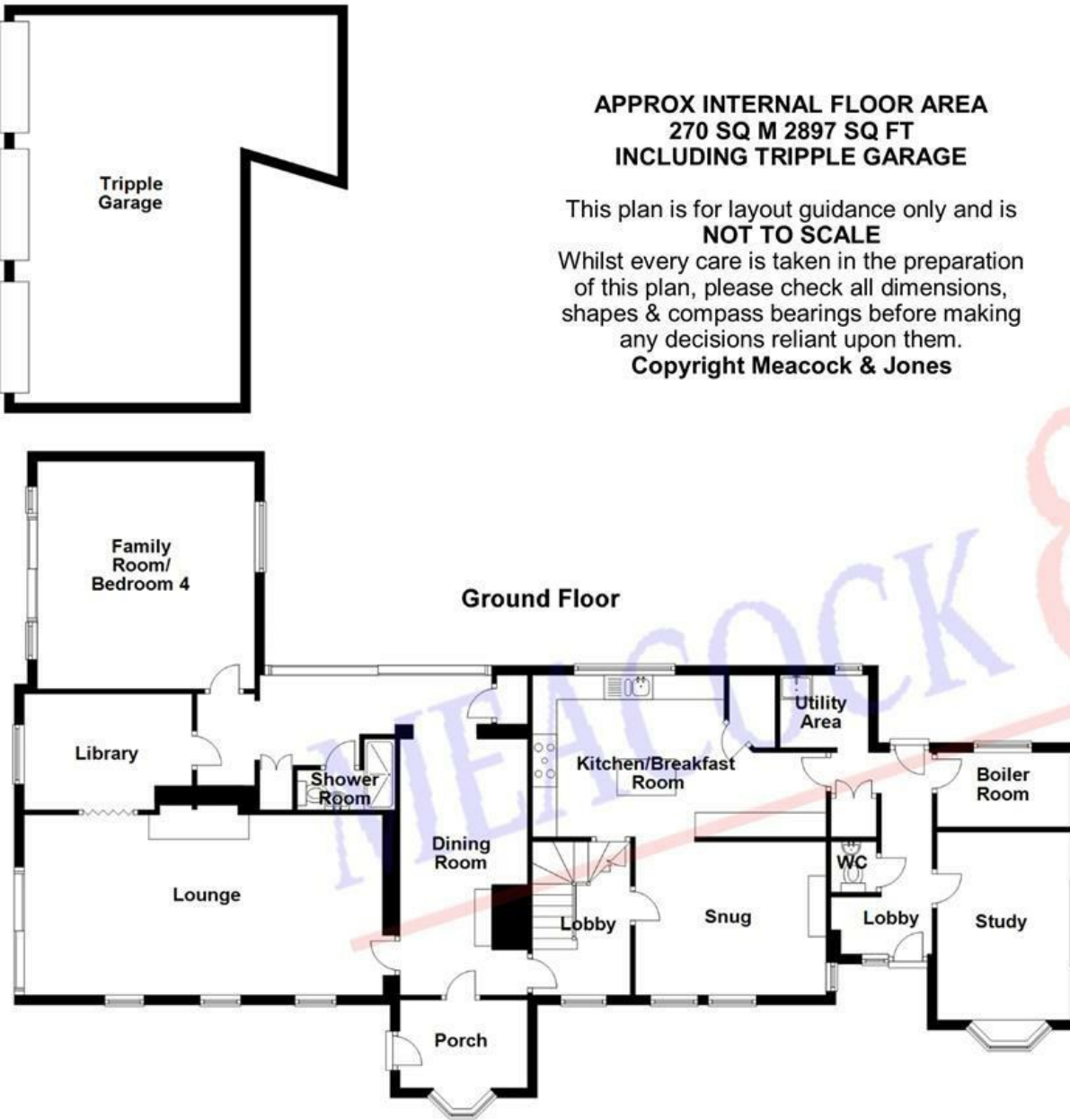

First Floor



Entrance Hall**Study**

12'9 max x 9'1

Ground Floor WC**Boiler Room**

9' x 4'6

Utility Room

4'7 x 4'5

Kitchen/Breakfast Room

19'7" > 14' x 10'6

Breakfast Room

12'9 x 10'5

Dining Room

17'4 x 10'6

Sitting Room

23'3 x 12'3

Library

11' x 8'0" > 6'

Family Room

15'4 x 14'4

Ground Floor Shower Room**First Floor Landing****Bedroom Two**

12'7 x 12'3

Bedroom Three

14'10 x 10'8

Family Bath/Shower Room**Primary Bedroom**

16' x 12'3 plus door recess

Externally**Triple Garage**

26' x 21" > 16'

MEACOCK & JONES

106 Hutton Road

Shenfield

Essex

CM15 8NB

01277 218485

enquiries@meacockjones.co.uk

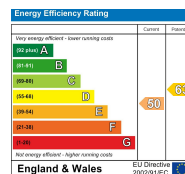
www.meacockjones.co.uk**Council Tax Band: G****Local Authority: Brentwood**

Whilst care has been exercised in the preparation of these particulars, statements about the property must not be relied upon as representations or statements of fact. Prospective purchasers must make and rely upon their own enquiries and those of their professional representatives. All measurements, areas and distances given are approximate. We have not tested any apparatus, equipment, fixtures, fittings or services and so cannot verify they are in working order. Any fixtures or fittings detailed in these particulars are not necessarily included in the sale price and Meacock & Jones and their staff accept no liability for any errors contained therein.

ZOOPLA**rightmove****onTheMarket.com****The Property Ombudsman****tsj**
APPROVED CODE
TRADING STANDARDS.GOV.UK**naea | propertymark**
PROTECTED