



790 Lower Rainham Road

Rainham, ME8 7UD

Offers over £675,000



Welcome to this beautifully presented detached chalet bungalow, set in a desirable location on Lower Rainham Road. Light, airy, and thoughtfully modernised, this stunning home has been lovingly maintained by the current owner, with no expense spared to present it in its naturally beautiful condition. Step inside and you'll immediately appreciate the space and versatility this property offers. The ground floor boasts a stylish high spec Ream-fitted kitchen/utility room, ideal for modern living, a spacious dining area leading into a bright and welcoming lounge with direct access to the rear garden, and a convenient downstairs W.C and separate shower room. There are also two generous bedrooms, one of which benefits from its own en suite shower room, perfect for guests or multigenerational living. Upstairs, you're welcomed by a generous landing that leads to three well-proportioned bedrooms and a modern family bathroom, creating a fantastic layout for growing families or those needing flexible living space.

Outside, the charm continues. The rear garden features a patio area ideal for entertaining or relaxing, and an attractive double garage with power and lighting, offering further space and practicality. Behind the garage is a large garden area with a feature and mature apple tree, a perfect space for gardening enthusiasts or further development (STPP). The property also benefits from ample off-road parking, making it ideal for busy households.

Providing peace of mind, this fine family home benefits from numerous security features.

Located just a short distance from Rainham station, this home is perfectly positioned for commuters while still offering peace and privacy in a sought-after area. NO CHAIN.



Door To

Hallway

Bedroom

11'4 x 8'4 (3.45m x 2.54m)

Bedroom

9'5 x 7'9 (2.87m x 2.36m)

En Suite

5'5 x 4'9 (1.65m x 1.45m)

W.C

5'1 x 3'1 (1.55m x 0.94m)

Shower Room

6'8 x 5'8 (2.03m x 1.73m)

Kitchen

13' x 7'9 (3.96m x 2.36m)

Utility Room

5'5 x 5' (1.65m x 1.52m)

Dining Room

13'3 x 8'2 (4.04m x 2.49m)

Lounge

16'8 x 14'9 (5.08m x 4.50m)

Stairs Up

Landing

Bedroom

15'3 x 12'9 (4.65m x 3.89m)

Office (restricted head height)

12'2 x 6'9 max (3.71m x 2.06m max)

Bathroom

7'9 x 5'8 (2.36m x 1.73m)

Bedroom

15' x 12'9 (4.57m x 3.89m)

Double Garage

18'7 x 17' (5.66m x 5.18m)

Garden

approx 100' x 30' (approx 30.48m x 9.14m)

Drive

approx 130' x 30' (approx 39.62m x 9.14m)

Important Notice -

Pollard Estates, their clients and any joint agents give notice that:

1. They have no authority to make or give any representations or warranties in relation to the property. These particulars do not form part of any offer or contract and must not be relied upon as statements or representations of fact. Any areas, measurements or distances are approximate. The text, photographs and plans are for guidance only and are not necessarily comprehensive.

2. It should not be assumed that the property has all necessary planning, building regulations or other consents and Pollard Estates have not tested any services, equipment or facilities. Purchasers must satisfy themselves by inspection or otherwise.

Area Map



Floor Plans

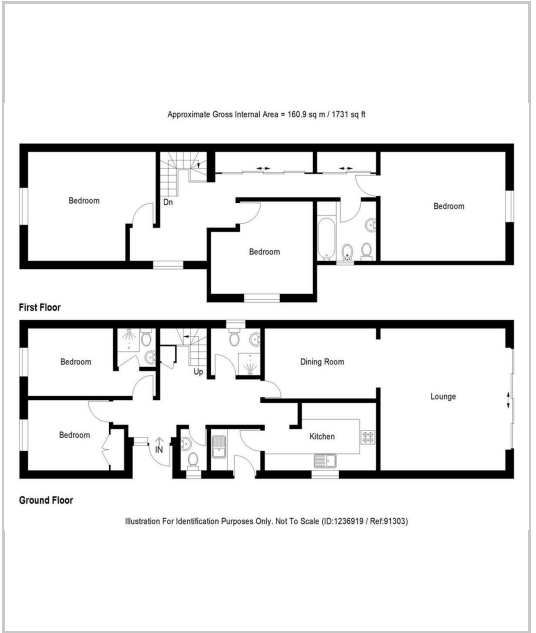

Energy Efficiency Graph

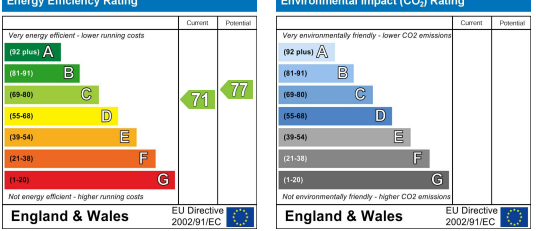

These particulars, whilst believed to be accurate are set out as a general outline only for guidance and do not constitute any part of an offer or contract. Intending purchasers should not rely on them as statements of representation of fact, but must satisfy themselves by inspection or otherwise as to their accuracy. No person in this firms employment has the authority to make or give any representation or warranty in respect of the property.