



16 Wildman Close

Rainham, ME8 9SL

Offers in excess of £265,000



A two double bedroom terrace house situated in a popular cul-de-sac and within easy reach of numerous schools, Parkwood shopping precinct and the A2/M2 motorway links.

Accommodation downstairs boasts a well proportioned lounge, kitchen/diner and conservatory.

Upstairs offers two lovely sized bedrooms and a bathroom. Also benefiting from a garage en-bloc and NO ONWARD CHAIN. An ideal first time buy!



Entrance Porch

5'9 x 5'0 (1.75m x 1.52m)

Lounge

15'2 x 13'4 (4.62m x 4.06m)

Kitchen/Diner

13'2 x 8'8 (4.01m x 2.64m)

Conservatory

11'9 x 6'9 (3.58m x 2.06m)

Stairs Up From Lounge

Landing

Bathroom

8'8 x 5 (2.64m x 1.52m)

Bedroom 1

10'3 x 10'1 (3.12m x 3.07m)

Bedroom 2

11'7 x 8'2 (3.53m x 2.49m)

Garden

25' x 15' apx (7.62m x 4.57m apx)

Garage En Bloc

Area Map



Floor Plans

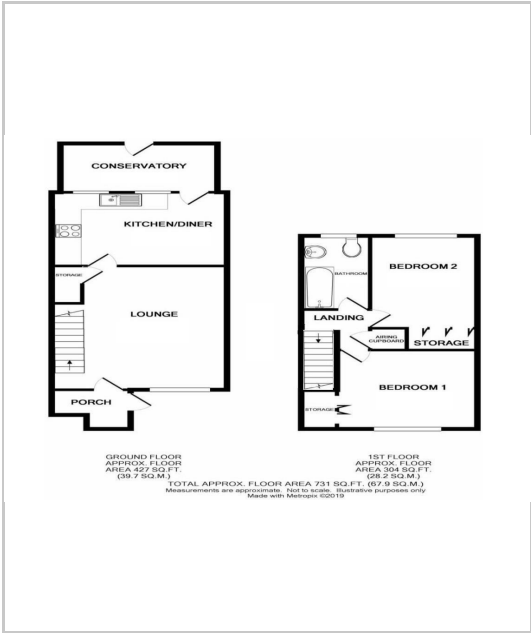

Energy Efficiency Graph

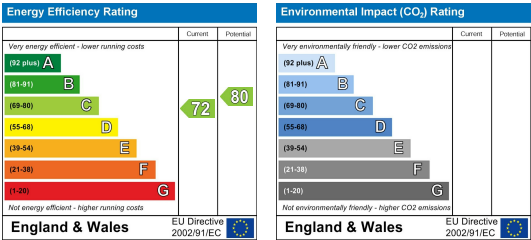

These particulars, whilst believed to be accurate are set out as a general outline only for guidance and do not constitute any part of an offer or contract. Intending purchasers should not rely on them as statements of representation of fact, but must satisfy themselves by inspection or otherwise as to their accuracy. No person in this firms employment has the authority to make or give any representation or warranty in respect of the property.