



133 Wallbridge Lane

Upchurch, ME8 7XD

Offers in excess of £375,000



A truly charming cottage which boasts both impressive presentation, and genuine character throughout. The well proportioned lounge includes a feature log burner with attractive exposed brick surround, the dining room enjoys ample room for entertaining and kitchen is considered both stylish and functional. The bathroom is also on the ground floor with a useful W.C upstairs. Upstairs offers 3 good sized bedrooms, the third is accessed off the second. Bedroom 3 also offers access to a boarded loft room. The unique selling point of this lovely home must surely be the superb position, offering direct views over Upchurch golf course. The rear garden also boasts a brick built outhouse and offers an array of beautiful plants and shrubs. Upchurch is a village on the edge of Rainham, offering a local shop, public house, post office, and primary school. A short drive brings you to Rainham, where you'll find a wealth of schools for all age groups, a mainline railway station, and a shopping precinct with a variety of shops and eateries.



Door to

Lounge

14'9" x 11'5" (4.5 x 3.5)

Hallway

Dining Room

14'9" x 11'5" (4.5 x 3.5)

Kitchen

11'9" x 8'2" (3.6 x 2.5)

Lobby

Bathroom

Stairs from Hallway to

Landing

Bedroom 1

14'9" x 11'5" (4.5 x 3.5)

Jack and Jill W.C

Bedroom 2

11'1" x 11'1" (3.4 x 3.4)

Bedroom 3 Off Bedroom 2

12'1" x 7'10" (3.7 x 2.4)

Stairs from Bedroom 2 to

Loft Room

Important Notice -

Area Map



Floor Plans

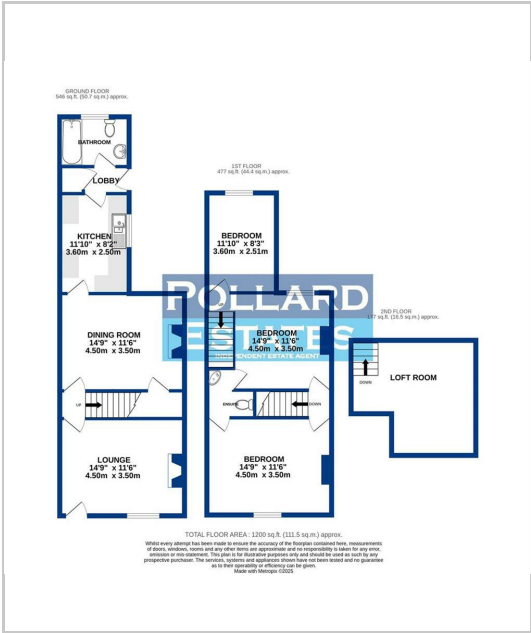

Energy Efficiency Graph

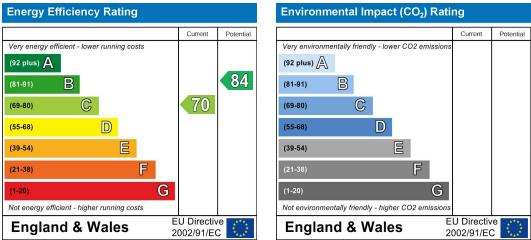

These particulars, whilst believed to be accurate are set out as a general outline only for guidance and do not constitute any part of an offer or contract. Intending purchasers should not rely on them as statements of representation of fact, but must satisfy themselves by inspection or otherwise as to their accuracy. No person in this firms employment has the authority to make or give any representation or warranty in respect of the property.