



## 5 Signals Close

Rainham, ME8 7NZ

Price guide £325,000



PRICE GUIDE £325,000 to £340,000. An extended bungalow offering attractive kerb appeal and a really welcoming and homely ambience. Accommodation includes a well proportioned lounge leading to light and airy dining area/sun room with sky light, a good size kitchen, bathroom and additional cloakroom with low level WC. Both bedrooms are considered generous in size and the sunny aspect and mature garden is a delight. Also offered with a driveway, car port and garage. Located in a quiet and tranquil cul-de-sac close to Rainham Station, local shops and Berengrave nature reserve. NO CHAIN.



Hallway

Lounge

12'4 x 12'1 (3.76m x 3.68m)

Dining Room/Sun Room

9'9 x 8'9 (2.97m x 2.67m)

Kitchen

12'5 x 8'7 (3.78m x 2.62m)

Bathroom

6'3 x 5'5 (1.91m x 1.65m)

Cloakroom

Bedroom 1

12'5 (into bay) x 10'9 (3.78m (into bay) x 3.28m)

Bedroom 2

12'4 x 7'10 (3.76m x 2.39m)

Garden

Garage

Driveway

Area Map



Floor Plans

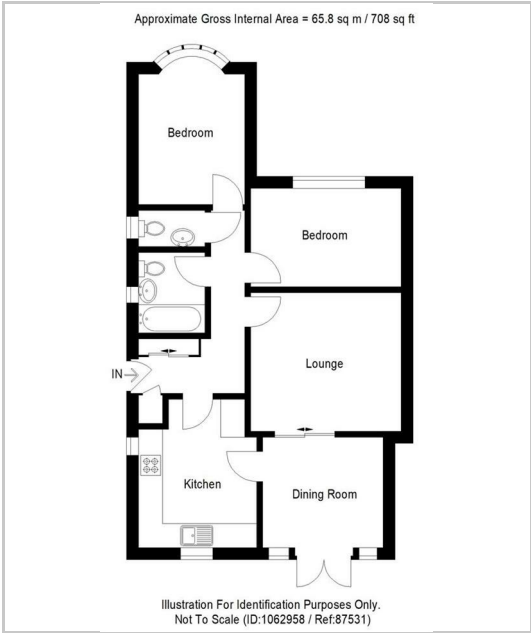

Energy Efficiency Graph

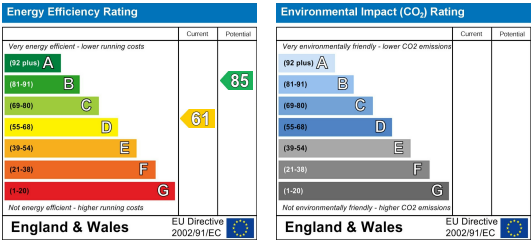

These particulars, whilst believed to be accurate are set out as a general outline only for guidance and do not constitute any part of an offer or contract. Intending purchasers should not rely on them as statements of representation of fact, but must satisfy themselves by inspection or otherwise as to their accuracy. No person in this firms employment has the authority to make or give any representation or warranty in respect of the property.