



256 Wigmore Road

Wigmore, ME8 0LZ

Guide price £500,000



A rarely available opportunity to purchase two good sized plots (measuring approx. 0.37 acres combined) offering enormous building potential for two properties (subject to planning permission). The current dwelling was one of the first ever built on Wigmore Road, it is timber framed and could offer temporary accommodation whilst building works commence. The location of this unique opportunity is highly desirable, a short drive away from numerous schools, motorway links, parks and Hempstead Valley Shopping centre. NO CHAIN.



Front Door

Porch

4'7 x 3'8 (1.40m x 1.12m)

Inner Hall

5'5 x 3'6 (1.65m x 1.07m)

Door To

Lounge

16' x 12'2 (4.88m x 3.71m)

Bedroom

15'9 x 11'8 (4.80m x 3.56m)

Bedroom

11'9 x 11'8 max (3.58m x 3.56m max)

Study (AGA)

16' x 6'7 (4.88m x 2.01m)

Kitchen

7'7 x 6'9 (2.31m x 2.06m)

Shower Room

5'9 x 4'10 (1.75m x 1.47m)

Rear Hallway

12'1 x 6'9 max (3.68m x 2.06m max)

Garden

Driveway

Area Map



Floor Plans

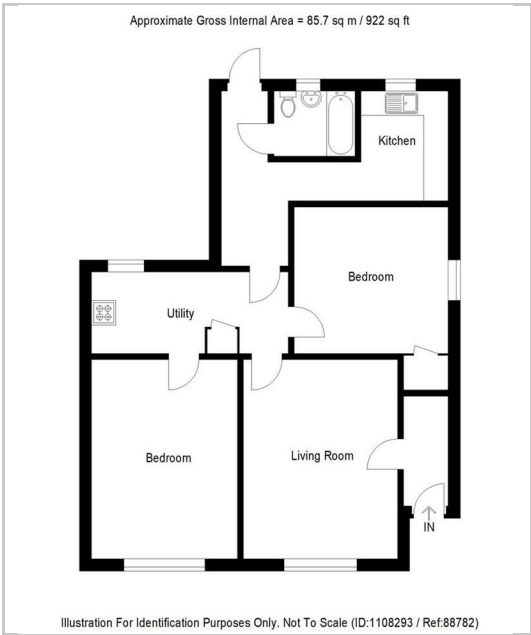

Energy Efficiency Graph

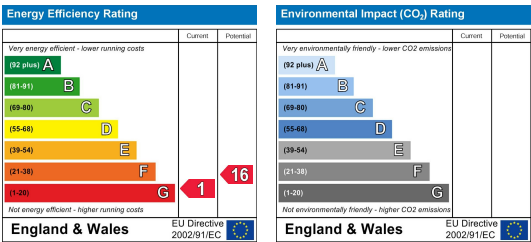

These particulars, whilst believed to be accurate are set out as a general outline only for guidance and do not constitute any part of an offer or contract. Intending purchasers should not rely on them as statements of representation of fact, but must satisfy themselves by inspection or otherwise as to their accuracy. No person in this firms employment has the authority to make or give any representation or warranty in respect of the property.