



17 Montrose Avenue

Darland, ME5 7HU

Offers in excess of £330,000



A spacious 3 bedroom period home situated in the ever popular Darland area of upper Gillingham. This traditionally configured house includes a separate lounge and dining room, kitchen and utility room downstairs. Upstairs offers 3 bedrooms and modern Shower room. Externally, the frontage provides a bloc paved driveway for parking and the low maintenance garden includes a useful garage to rear. A lovely family home boasting superb kerb appeal and located close to a plethora of local shops and restaurants. NO CHAIN, must be viewed!



Porch

Hallway

Lounge

14'1 x 13'3 max (4.29m x 4.04m max)

Dining Room

12'3 x 11'3 (3.73m x 3.43m)

Kitchen

11'8 x 7'4 (3.56m x 2.24m)

Utility Room

5'5 x 3'2 (1.65m x 0.97m)

Stairs Up

Shower Room

7'7 x 6'7 (2.31m x 2.01m)

Bedroom One

12'3 x 11'9 to cupboard (3.73m x 3.58m to cupboard)

Bedroom Two

12'3 x 9'9 (3.73m x 2.97m)

Bedroom Three

7'5 x 7'0 (2.26m x 2.13m)

Garden

Garage To Rear

Driveway

Area Map



Floor Plans

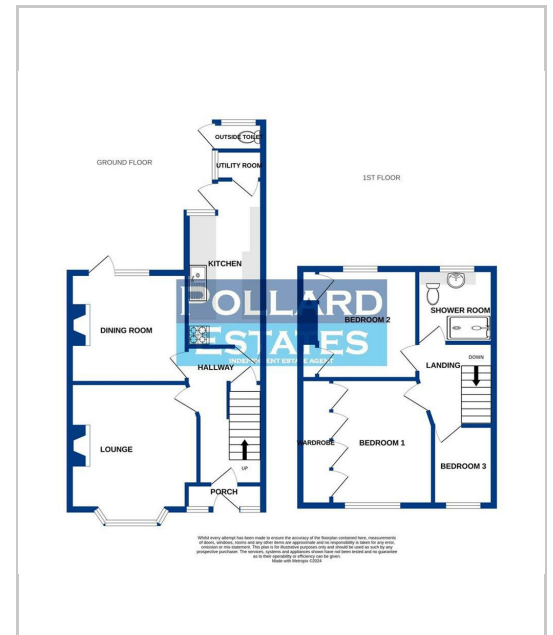

Energy Efficiency Graph

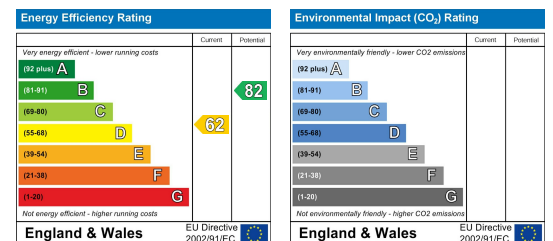

These particulars, whilst believed to be accurate are set out as a general outline only for guidance and do not constitute any part of an offer or contract. Intending purchasers should not rely on them as statements of representation of fact, but must satisfy themselves by inspection or otherwise as to their accuracy. No person in this firm's employment has the authority to make or give any representation or warranty in respect of the property.