



## 1 Wentworth Drive

Rainham, ME8 9BB

£400,000



Pollard Estates are delighted to offer this stunning bungalow situated on a beautifully maintained corner plot with pleasant gardens to front and rear. The current vendor has thoughtfully invested time and money to improve many aspects in order to enhance the overall appeal. A gated driveway and immaculate presentation throughout also add to the charm and attraction. The sizable roof space and large cupboard offer the potential for access to create a loft conversion (STPP). Conveniently located, the property is situated in a highly popular location close to bus routes and local shops. The rare bonus of having an en-suite and bathroom ensures an internal viewing is highly recommended!



## Entrance Hall

## Lounge/Diner

16'8 (max) x 15' (max) (5.08m (max) x 4.57m (max))

## Loggia Style Conservatory

11'9 x 8'10 (3.58m x 2.69m)

## Kitchen

10'10 x 6'10 (3.30m x 2.08m)

## Bedroom 1

16' (max) x 11'8 (4.88m (max) x 3.56m)

## En-Suite Shower Room

## Bedroom 2

10'10 x 7'6 (3.30m x 2.29m)

## Bathroom

6'7 x 5'5 (2.01m x 1.65m)

## Established Corner Plot Gardens

## Gated Driveway

## Garage With Utility Area

22'6 x 8'9 (max) (6.86m x 2.67m (max))

## Area Map



## Floor Plans

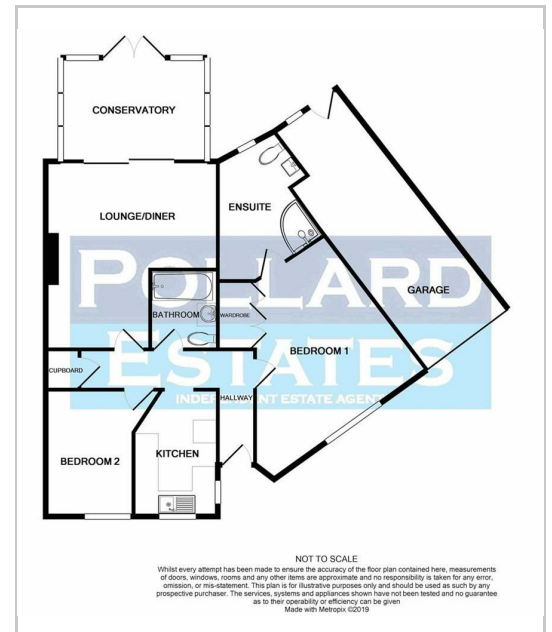

## Energy Efficiency Graph

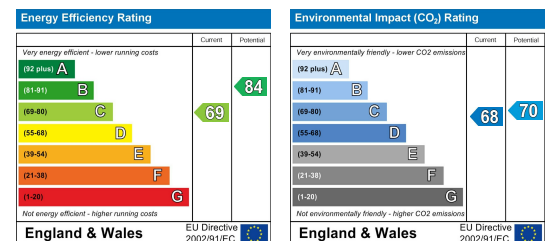

These particulars, whilst believed to be accurate are set out as a general outline only for guidance and do not constitute any part of an offer or contract. Intending purchasers should not rely on them as statements of representation of fact, but must satisfy themselves by inspection or otherwise as to their accuracy. No person in this firm's employment has the authority to make or give any representation or warranty in respect of the property.