



45 Northumberland Avenue

Rainham, ME8 7JY

Guide price £375,000



Guide Price £375,000 to £400,000

A impressive semi detached house offering light, airy and high specification accommodation. The current owner has invested significant time and money improving almost all aspects of this fine home. Downstairs has a modern and contemporary feel with a superb kitchen and spacious lounge/diner. Upstairs comprises of two double bedrooms, a decent sized third and a superbly presented shower room with double width waterfall shower cubicle. Perhaps the most unique and rare benefit is the large studio/gym (formerly garage) offering flexible use including working from home/additional living space. There is potential to extend into the loft, subject to planning. The secluded rear garden benefits from remote feature lighting with side access. A stunning house, simply must be viewed! Northumberland Avenue is ideally located for local shops, parks, Rainham Train Station and numerous schools.



Hallway

Lounge

14'6 into bay x 11'3 (4.42m into bay x 3.43m)

Dining Area

9'9 x 8'7 (2.97m x 2.62m)

Kitchen

11'8 x 8'2 (3.56m x 2.49m)

Stairs Up to Landing

Shower Room

6'4 x 5'5 (1.93m x 1.65m)

Bedroom One

14'1 into bay x 9'8 (4.29m into bay x 2.95m)

Bedroom Two

11'2 x 10'7 (3.40m x 3.23m)

Bedroom Three

8'2 x 7'3 (2.49m x 2.21m)

Garden

Studio/Gym/Workshop

17'5 x 15'7 (5.31m x 4.75m)

Area Map



Floor Plans

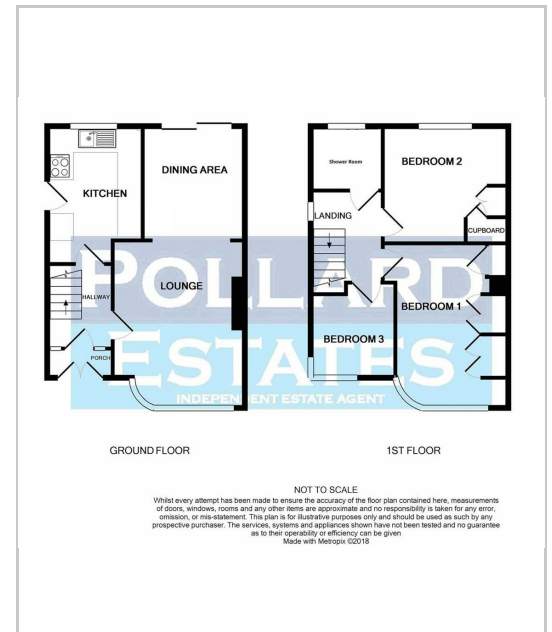

Energy Efficiency Graph

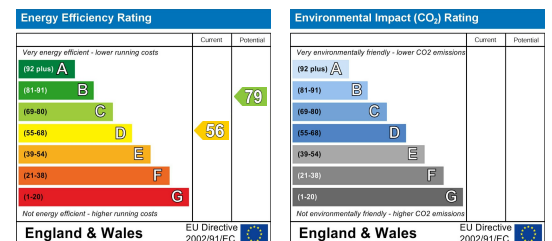

These particulars, whilst believed to be accurate are set out as a general outline only for guidance and do not constitute any part of an offer or contract. Intending purchasers should not rely on them as statements of representation of fact, but must satisfy themselves by inspection or otherwise as to their accuracy. No person in this firm's employment has the authority to make or give any representation or warranty in respect of the property.