



8 Hartpiece Close

Rainham, ME8 7SX

Guide price £315,000



PRICE GUIDE £315,000 to £325,000. A 2 bedroom detached bungalow situated in a sought after cul-de-sac yet within walking distance to Rainham Station, shopping precinct and bus routes. Accommodation includes a modern shower room, kitchen, a well proportioned lounge, attractive conservatory which over looks the lovely and sunny aspect garden and an additional side conservatory/study. The driveway offers parking for several cars. Detached bungalows are seldom available in this price range and location so your earliest viewing opportunity is highly recommended. NO CHAIN.



Entrance Hallway

Bedroom 2

10'4" max x 7'8" (3.15m max x 2.34m)

Shower Room

7'1 x 4'5 (2.16m x 1.35m)

Kitchen

9'2 x 7'3 (2.79m x 2.21m)

Bedroom 1

10'1 x 9'3 (3.07m x 2.82m)

Lounge

13'10 x 12'8 (4.22m x 3.86m)

Rear Conservatory

10'4 x 9'2 (3.15m x 2.79m)

Side Conservatory/Study

10'1 x 7'4 (3.07m x 2.24m)

Garden

Driveway

Area Map



Floor Plans

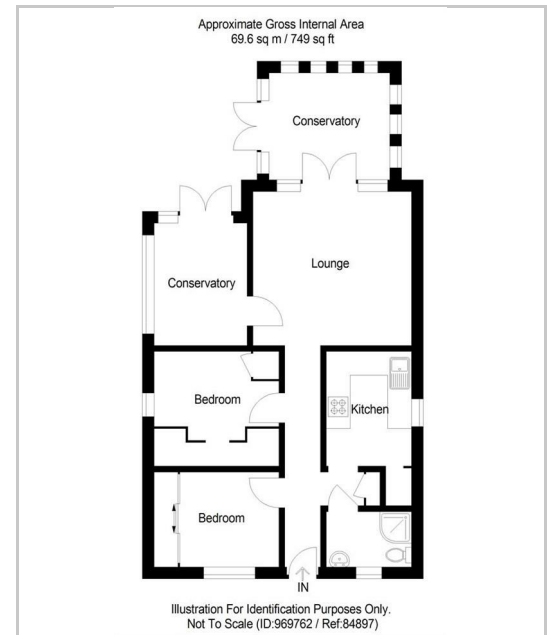

Energy Efficiency Graph

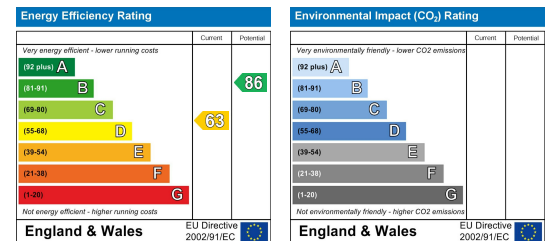

These particulars, whilst believed to be accurate are set out as a general outline only for guidance and do not constitute any part of an offer or contract. Intending purchasers should not rely on them as statements of representation of fact, but must satisfy themselves by inspection or otherwise as to their accuracy. No person in this firm's employment has the authority to make or give any representation or warranty in respect of the property.