

14 Bridge Street, Thetford, Norfolk, IP24 3AA
Tel: 01842 754161
thetford@chilternsestateagents.co.uk
www.shiresresidential.com

chilterns

Estate & Letting Agents



Columbine Close, Thetford, IP24 2YF

Rent - £950 PCM

Deposit - £1,096

Available now, this well-presented two-bedroom house is located on the popular Cloverfield development and is ready to move straight into. The property offers a fitted kitchen, a bright lounge with doors opening onto an enclosed rear garden, two good-sized bedrooms and a family bathroom. With a patio and lawn to the rear and convenient access to local amenities, this home is ideal for tenants looking for comfortable, low-maintenance living. Early viewing is highly recommended to avoid missing out.

- TWO BEDROOMS
- KITCHEN & FAMILY BATHROOM
- ENCLOSED REAR GARDEN
- NEARBY TO RAF BASES
- COUNCIL TAX BAND - A
- ELECTRIC HEATING
- ALLOCATED PARKING
- NEARBY TO LOCAL AMENITIES
- EPC RATING E - 50
- AVAILABLE NOW!



Council Tax Band: A - EPC Rating: E 50

GROUND FLOOR
26.6 sq.m. (286 sq.ft.) approx.

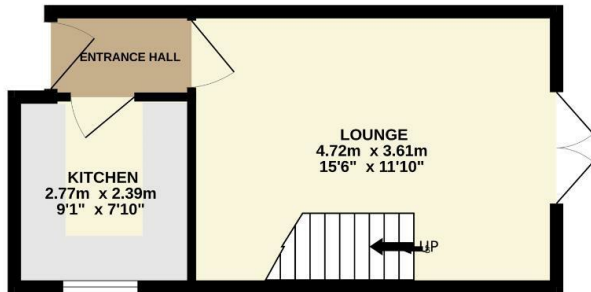

1ST FLOOR
25.2 sq.m. (271 sq.ft.) approx.

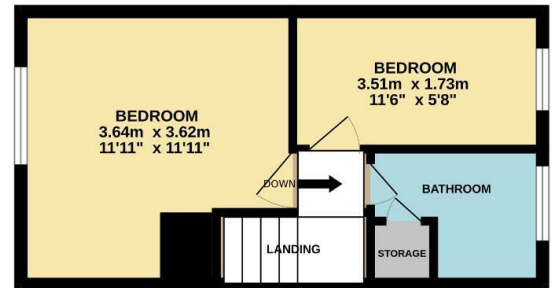

TOTAL FLOOR AREA : 51.8 sq.m. (557 sq.ft.) approx.

Whilst every attempt has been made to ensure the accuracy of the floorplan contained here, measurements of doors, windows, rooms and any other items are approximate and no responsibility is taken for any error, omission or mis-statement. This plan is for illustrative purposes only and should be used as such by any prospective purchaser. The services, systems and appliances shown have not been tested and no guarantee as to their operability or efficiency can be given.

Made with Metropix ©2026

