

14 Bridge Street, Thetford, Norfolk, IP24 3AA
Tel: 01842 754161
thetford@chilternsestateagents.co.uk
www.shiresresidential.com

chilterns

Estate & Letting Agents



Tennyson Way, Norfolk, IP24 1LD

Rent - £180,000 Deposit -

This two bedroom property is situated on the popular Woodlands development and lies within both Drake Primary School and Thetford Academy catchment area.

- POPULAR WOODLANDS DEVELOPMENT
- NORTH OF THETFORD
- WELL PRESENTED THROUGHOUT
- GAS CENTRAL HEATING
- TWO ALLOCATED PARKING SPACES
- WALKING DISTANCE OF PRIMARY AND HIGH SCHOOLS
- GREAT ACCESS TO A11 FOR COMMUTERS
- TWO BEDROOM MID TERRACED HOUSE
- ENCLOSED REAR GARDEN
- VIEWINGS HIGHLY ADVISED!



Council Tax Band: B - EPC Rating: C 70

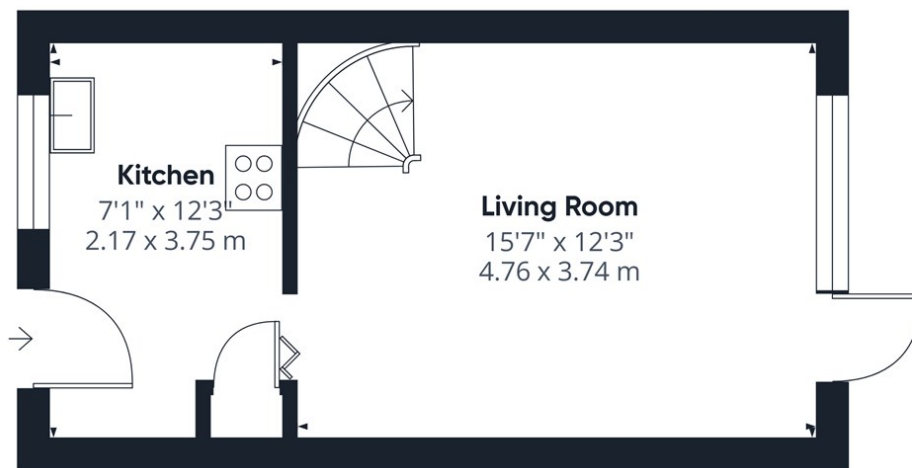

Ground Floor

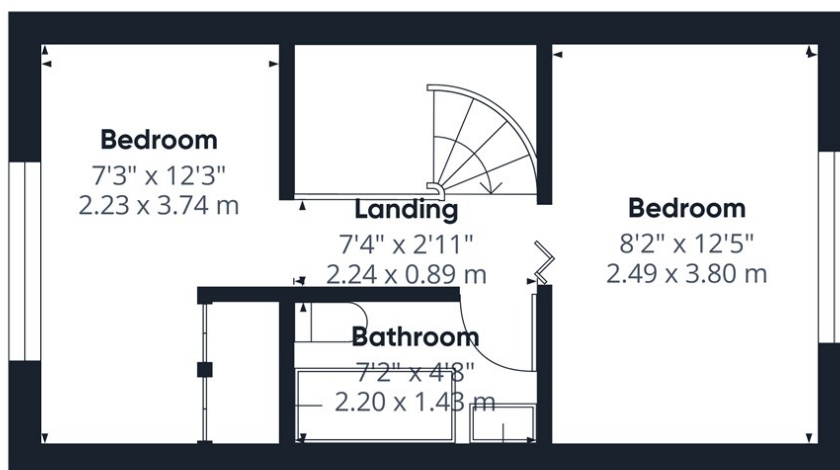

Floor 1

Approximate total area⁽¹⁾

561 ft²

52.1 m²

Reduced headroom

31 ft²

2.9 m²

(1) Excluding balconies and terraces

Reduced headroom

..... Below 5 ft/1.5 m

Calculations reference the RICS IPMS 3C standard. Measurements are approximate and not to scale. This floor plan is intended for illustration only.

GIRAFFE360

