

eddissonwhite®



34 christchurch road, colliers wood, SW19 2NX

85 the broadway, wimbledon, SW19 1QE

109 london road, morden, SM4 5HP

W eddissonwhite.co.uk

T 020 8540 9828



## London Road, Mitcham

Offers In Excess Of £225,000 Leasehold

1 Double Bedroom - Ground Floor - 10 Year Old Building

Immaculate Condition - Contemporary Kitchen & Bathroom

Option To Rent 2x Parking Space & Storage Unit - Shops On Door Step

Short Walk To Train & Tram - Elegant Living/Diner - EPC 'C'



company registration no. 05068639 • vat registration no. 843560623



# London Road, Mitcham

## Ground Floor

Approx. 35.8 sq. metres (384.9 sq. feet)

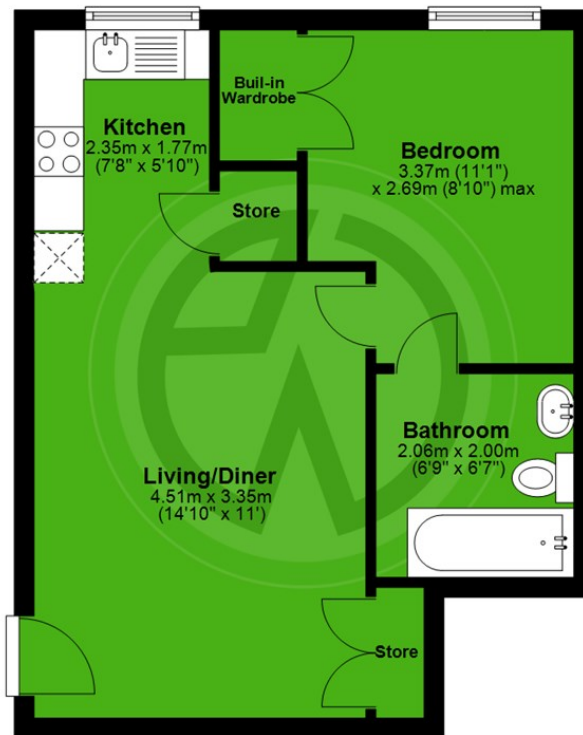

Total area: approx. 35.8 sq. metres (384.9 sq. feet)

Whilst every attempt has been made to ensure the accuracy of the floor plan, measurements of doors, windows and rooms are approximate and no responsibility is taken for any error, omission or misstatement. These plans are for representation only and should be used as such by prospective purchasers. Specifically no guarantee is given on the gross internal floor area of the property if quoted on this plan and any figure given is for guidance only and should not be relied on as a basis of valuation. Plan produced using PlanUp.

London Borough of Merton

Tax Band B

Leasehold

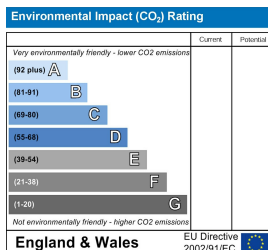
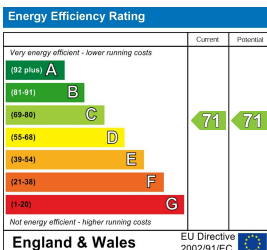

These details and any pictures or plans represent our opinion and are given in good faith for guidance only. They must not be construed as statements or fact. These particulars do not constitute part of an offer or contract. We have not tested the services, appliances or specified fittings and would highly recommend a purchaser to carry out their own survey on the property.