

eddissonwhite®



34 christchurch road, colliers wood, SW19 2NX

85 the broadway, wimbledon, SW19 1QE

109 london road, morden, SM4 5HP

W eddissonwhite.co.uk

T 020 8540 9828



Kipling Drive, Wimbledon

Offers In Excess Of £300,000 Leasehold

One Double Bedroom - First Floor - Modern Development - EPC: C

Bright & Airy Lounge - Entry Phone System - Stylish Kitchen

Bathroom With Shower Over - Excellent Condition - Popular Location

Off Street Parking - Close To Colliers Wood Tube - 954 yr Lease



company registration no. 05068639 • vat registration no. 843560623



Kipling Drive, Wimbledon

Kipling Drive, London, SW19

Approximate Area = 441 sq ft / 40.9 sq m

For identification only - Not to scale

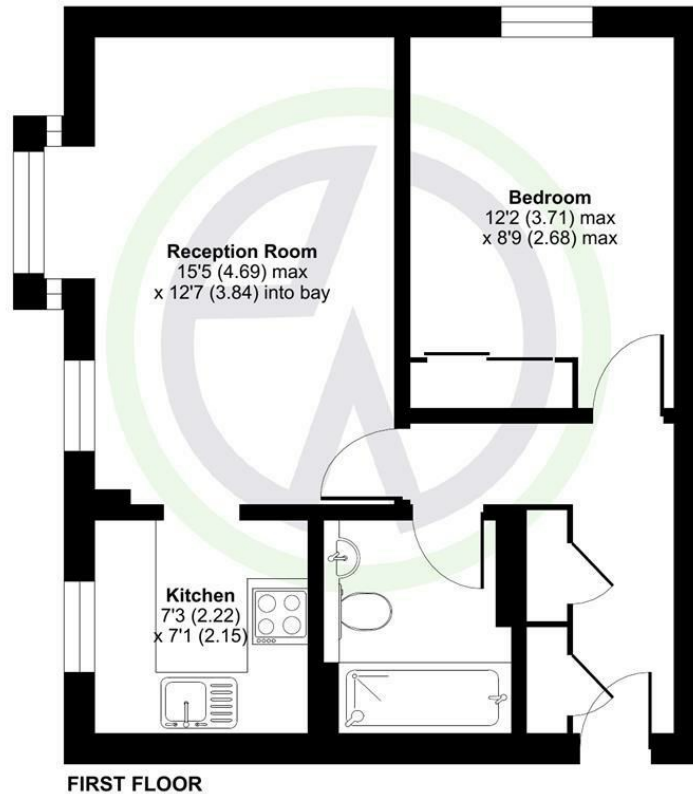

Floor plan produced in accordance with RICS Property Measurement 2nd Edition, Incorporating International Property Measurement Standards (IPMS2 Residential). Produced for Eddison White. REF: 1248452. © nrichcom 2025.



London Borough of Merton
Tax Band C
Leasehold

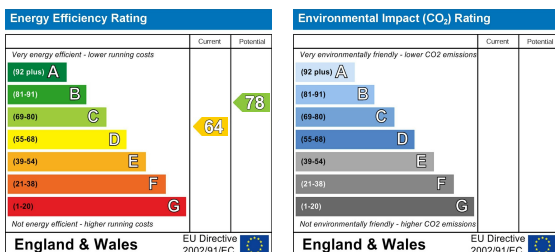

These details and any pictures or plans represent our opinion and are given in good faith for guidance only. They must not be construed as statements or fact. These particulars do not constitute part of an offer or contract. We have not tested the services, appliances or specified fittings and would highly recommend a purchaser to carry out their own survey on the property.