

eddissonwhite®



34 christchurch road, colliers wood, SW19 2NX

85 the broadway, wimbledon, SW19 1QE

109 london road, morden, SM4 5HP

W eddissonwhite.co.uk

T 020 8540 9828



Bridges Road Mews, Wimbledon

Guide Price £275,000 Leasehold - Share of Freehold

Share of Freehold - Studio/1 Bedroom Flat - Terraced Area

Modern Fitted Kitchen - Contemporary Shower Room

South Park Area of Wimbledon - Gas Central Heating

Good Condition - EPC E - Lease 999 years from 27.07.2012



company registration no. 05068639 • vat registration no. 843560623



Bridges Road Mews, Wimbledon

Bridges Road Mews, London, SW19

Approximate Area = 292 sq ft / 27.1 sq m
For identification only - Not to scale

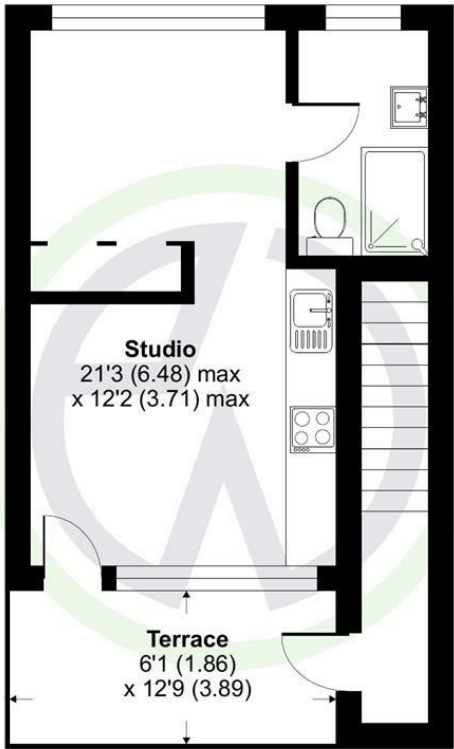

FIRST FLOOR

Floor plan produced in accordance with RICS Property Measurement 2nd Edition, Incorporating International Property Measurement Standards (IPMS2 Residential). Produced for Edissonwhite. REF: 1248701



London Borough of Merton
Tax Band B
Leasehold - Share of Freehold

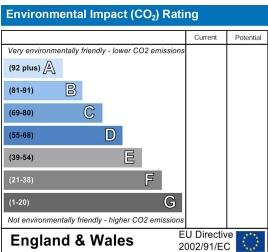
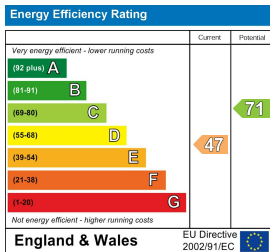

These details and any pictures or plans represent our opinion and are given in good faith for guidance only. They must not be construed as statements or fact. These particulars do not constitute part of an offer or contract. We have not tested the services, appliances or specified fittings and would highly recommend a purchaser to carry out their own survey on the property.