

eddissonwhite®



34 christchurch road, colliers wood, SW19 2NX

85 the broadway, wimbledon, SW19 1QE

109 london road, morden, SM4 5HP

 eddissonwhite.co.uk

 020 8540 9828



## Watermill Way, Colliers Wood

£375,000 Leasehold - Share of Freehold

1 Double Bedroom - Open Plan Cotemporary Kitchen - EPC 'D'  
Modern Bathroom - Floor To Ceiling Windows - 30ft Private Terrace  
River Wandle Views - Within The Merton Abbey Mills Development  
Short Walk To Colliers Wood Tube - Share Of Freehold - No Chain



company registration no. 05068639 • vat registration no. 843560623



# Watermill Way, Colliers Wood

## Bennets Courtyard, Watermill Way, London, SW19

Approximate Area = 506 sq ft / 47 sq m  
For identification only - Not to scale

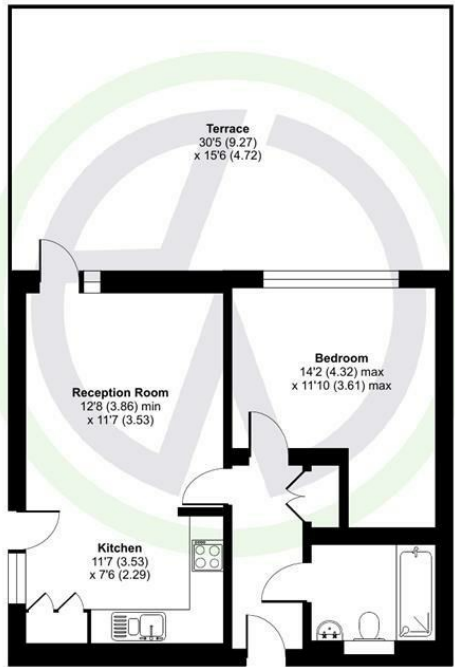

FIRST FLOOR



Floor plan produced in accordance with RICS Property Measurement 2nd Edition, Incorporating International Property Measurement Standards (IPMS2 Residential). Produced for Eddison White. REF: 1234383. © nrdhcom 2025.



London Borough of Merton  
Tax Band C  
Leasehold - Share of Freehold

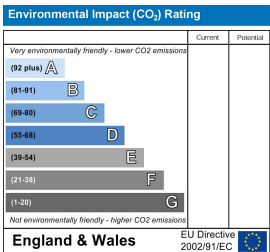
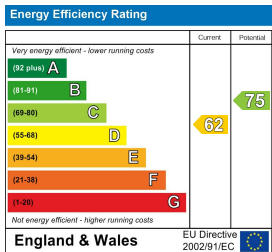

These details and any pictures or plans represent our opinion and are given in good faith for guidance only. They must not be construed as statements or fact. These particulars do not constitute part of an offer or contract. We have not tested the services, appliances or specified fittings and would highly recommend a purchaser to carry out their own survey on the property.



company registration no. 05068639 • vat registration no. 843560623

