



## Heathfield Drive, Mitcham

£2,200 Per Calendar Month

3 Bedrooms - End Of Terrace - Off-Street Parking  
Large Living Room - Stylish Kitchen - Dining Room  
50' Garden - Modern Bathroom - Available 6th May  
Part-furnished - Colliers Wood Borders - EPC 'C'



# Heathfield Drive, Mitcham

## Ground Floor

Approx. 35.1 sq. metres (377.7 sq. feet)

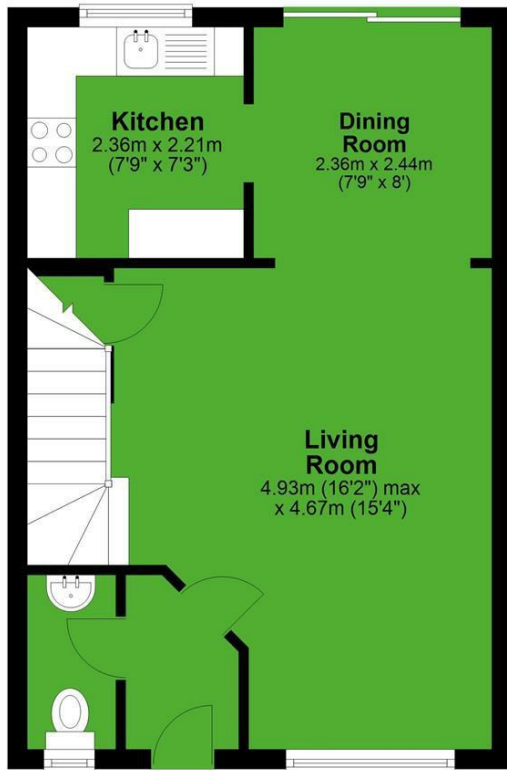

## First Floor

Approx. 35.6 sq. metres (383.2 sq. feet)



Total area: approx. 70.7 sq. metres (760.9 sq. feet)

London Borough of Merton  
Tax Band D

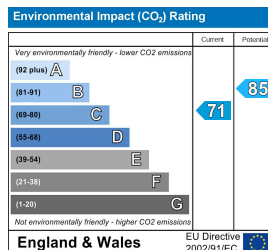
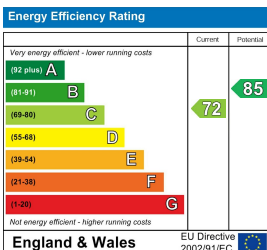

These details and any pictures or plans represent our opinion and are given in good faith for guidance only. They must not be construed as statements or fact. These particulars do not constitute part of an offer or contract. We have not tested the services, appliances or specified fittings and would highly recommend a purchaser to carry out their own survey on the property.