



Scan me to get a **detailed property report & valuation** on your house!



Ilam Court, Rugby
Offers Over £140,000

complete ●●●
ESTATE AGENTS

Ilam Court, Rugby,

- A fantastic rental or for first time buyers.
- Good size rooms
- Garage and parking
- Two double bedrooms

Located close to local amenities and good road links around rugby and further afield.
for more information and to arrange a viewing call 01788 550800

Hallway

Small space for shoes then straight upstairs to the property.

Living room 17'8" x 10'9" (5.4 x 3.3)

A good size room that could easily accommodate a dining table too if required.

Kitchen 7'2" x 7'10" (2.2 x 2.4)

A u shaped space with plenty of storage and work surface with space for a fridge freezer and a washing machine.

Bedroom one 12'1" x 8'10" (3.7 x 2.7)

A good double bedroom with space for wardrobes and further storage.



Bedroom two 9'6" x 6'10" (2.9 x 2.1)

A small double or large single room with space for storage.

Bathroom 6'6" x 5'6" (2 x 1.7)

A white suite with a shower over the bath and storage space.

About Rugby

Rugby is a market town in Warwickshire, England, on the River Avon. The town has a population of 70,628 (2011 census[1]) making it the second largest town in the county. The enclosing Borough of Rugby has a population of 100,500 (2011 census). Rugby is 13 miles (21 km) east of Coventry, on the eastern edge of Warwickshire, near the borders with Northamptonshire and Leicestershire. The town is credited with being the birthplace of rugby football.

Rugby Borough Council

Rugby Borough Council,
Town Hall,
Evreux Way,
Rugby
CV21 2RR

Leasehold

The property is leasehold.
Lease left 134 yrs,
Ground rent £100.97 each six monthly.
Service charge £931.85 yearly.



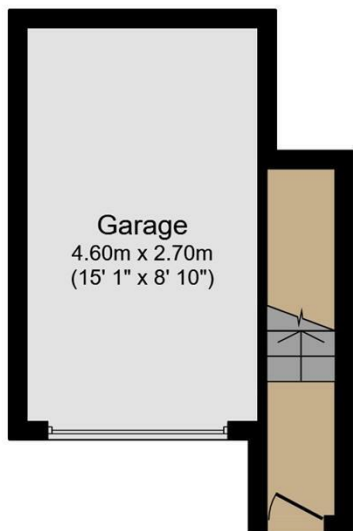

Ground Floor

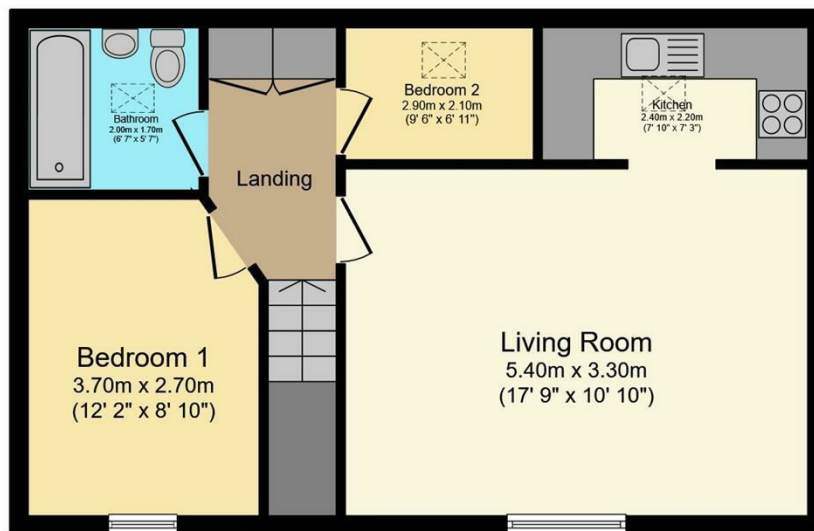

First Floor

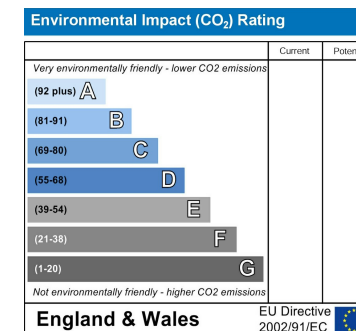
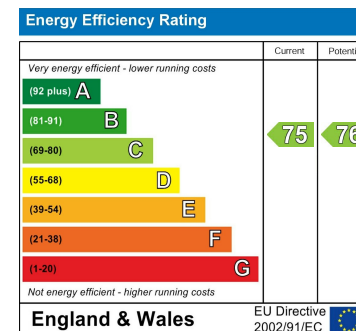

Total floor area 67.8 sq.m. (730 sq.ft.) approx

This plan is for illustration purposes only and may not be representative of the property. Plan not to scale. Powered by PropertyBox

Misrepresentation Act 1967 - These particulars are believed to be correct but their accuracy is not guaranteed nor do they form part of any contract.

18 Church Street, Rugby, Warwickshire, CV21 3PU
 T: 01788 550 800
 sales@complete247.co.uk
 www.complete247.co.uk

complete ●●●
 ESTATE AGENTS