



## Gaisford Street, NW5

£425 Per calendar month

A charming one-bedroom period conversion featuring a private garden, ideally located just off Kentish Town High Street. The property also benefits from its own private entrance, wooden flooring throughout, and a built-in office area off the hallway.

Gaisford Street is a sought-after residential turning, conveniently positioned near Kentish Town tube station and well-regarded local amenities, including Earth Health Food Store, Gail's, and Kossoff's Bakery.

### Features

- One Bedroom
- Period Conversion
- Coveted Road
- Moments From Amenities
- South Facing Garden
- Private Entrance

# Gaisford Street, London, NW5

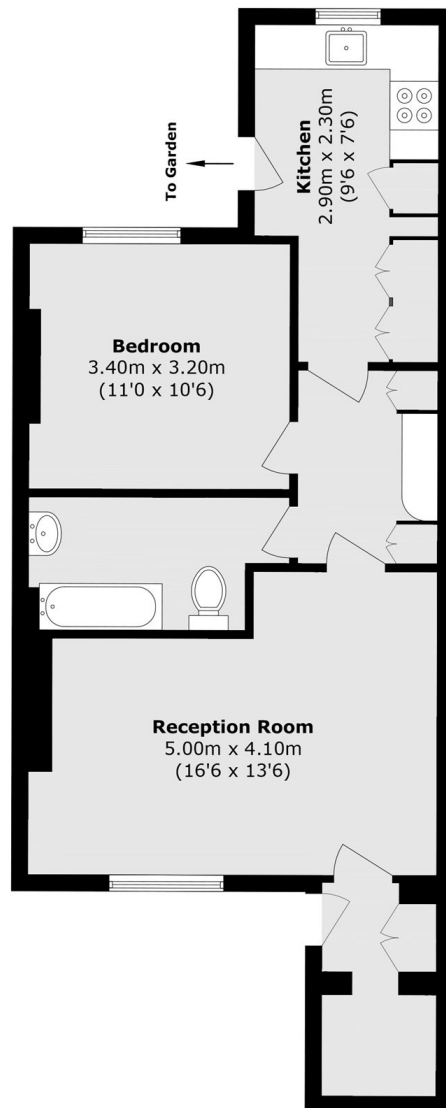

Total area (approx.): 52.0 sq. m (566.0 sq. ft)